

DUCT SPECIFICATION

| | |
|----|-----------------------------|
| 1. | 26 GAUGE - 1-750 mm TDF |
| 2. | 24 GAUGE - 751-1050 mm TDF |
| 3. | 22 GAUGE - 1051-1200 mm TDF |
| 4. | 20 GAUGE - 1201-2100 mm TDF |

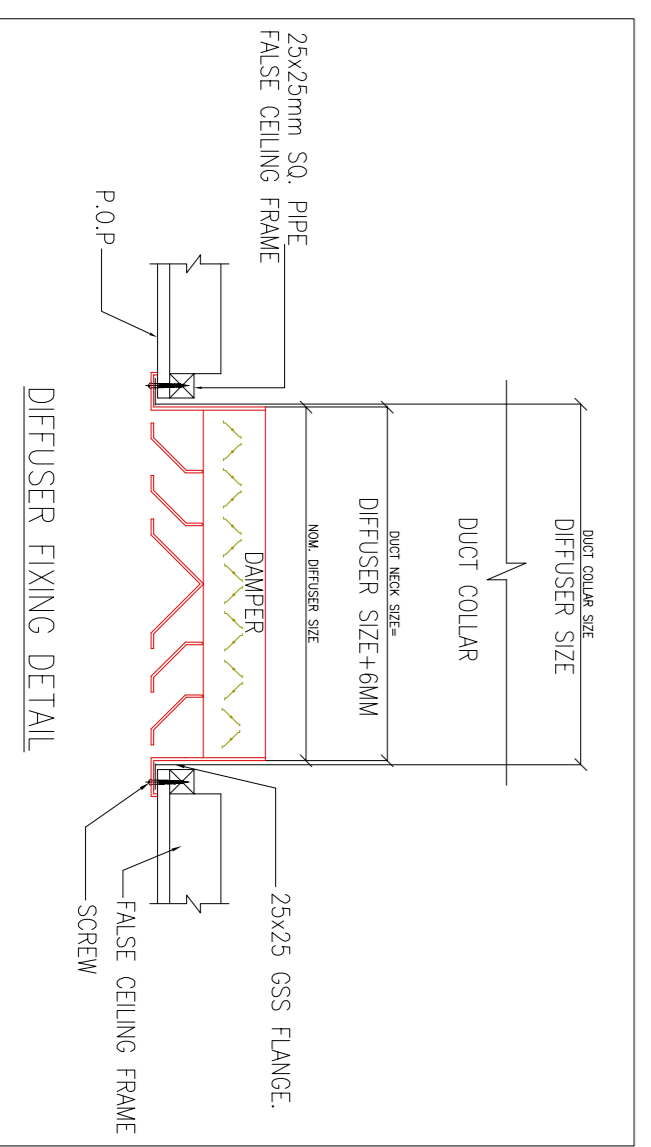
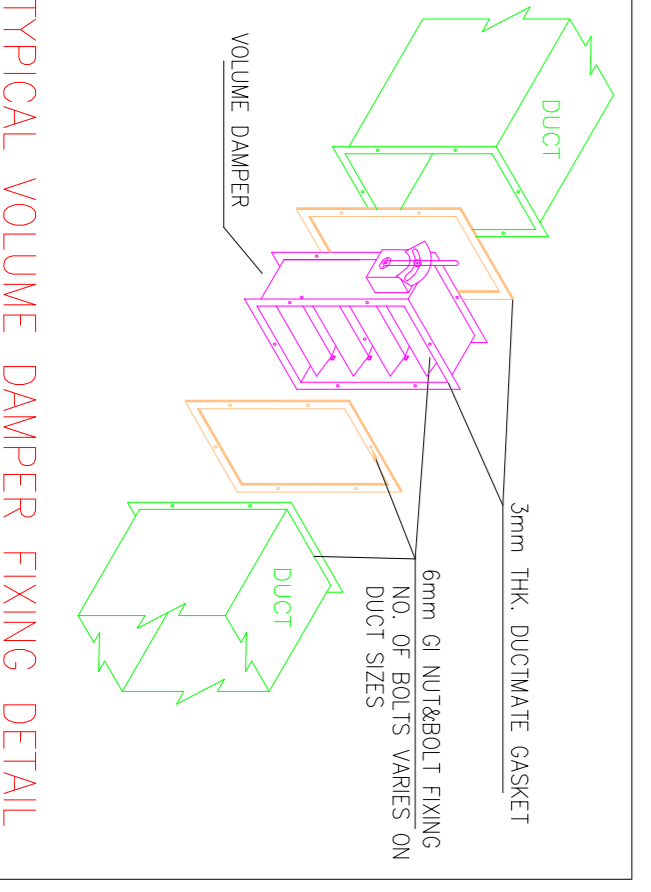
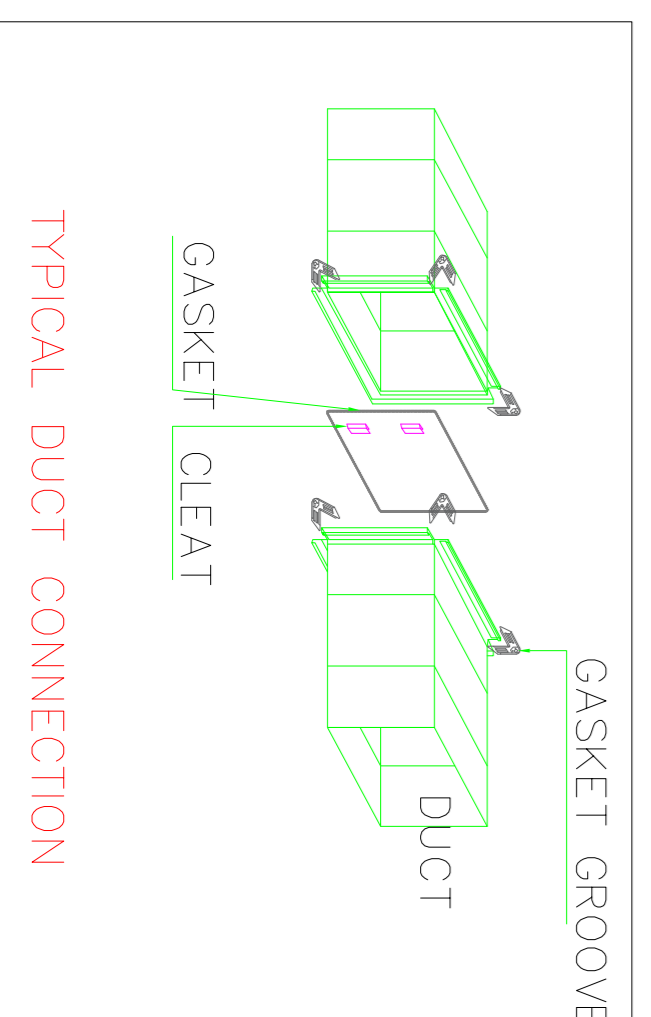

NOTES

1. All dimensions are in millimeters.
2. All floor area is to be finished to the finished floor level.
3. All wall area is to be finished to the finished wall level.
4. All ceiling area is to be finished to the finished ceiling level.
5. All ductwork is to be installed in accordance with the applicable codes and standards.
6. All ductwork is to be installed in accordance with the applicable codes and standards.
7. All ductwork is to be installed in accordance with the applicable codes and standards.
8. All ductwork is to be installed in accordance with the applicable codes and standards.
9. All ductwork is to be installed in accordance with the applicable codes and standards.
10. All ductwork is to be installed in accordance with the applicable codes and standards.

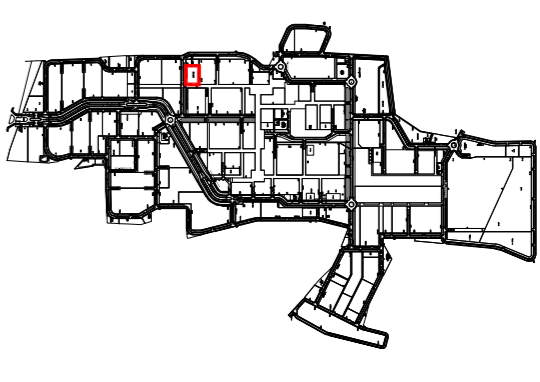

NOTE: MAIN FLOOR PLAN AND SPLIT PLANS FOR THE ABSOLUTE LEVEL, UP TO THE FINISHED FLOOR LEVEL.

STAMP

| REVISION | DESCRIPTION | DATE |
|----------|-------------|------|
| | | |
| | | |

ISSUES

| | | |
|--|--|--|
| | | |
| | | |
| | | |

CLIENTS:
 PROJECT: [Project Name]
 CLIENT: [Client Name]
 ADDRESS: [Address]
 CONTACT: [Contact Info]

DESIGNER:
 PROJECT: [Project Name]
 DESIGNER: [Designer Name]
 ADDRESS: [Address]
 CONTACT: [Contact Info]

CONCRETE ENGINEERING CONSULTANT:
 PROJECT: [Project Name]
 CONSULTANT: [Consultant Name]
 ADDRESS: [Address]
 CONTACT: [Contact Info]

MEP CONSULTANTS:
 PROJECT: [Project Name]
 CONSULTANTS: [Consultants Name]
 ADDRESS: [Address]
 CONTACT: [Contact Info]

Document Release Type:
 TENDER / GOOD FOR CONSTRUCTION

Job No.: 202895
Scale: 1:100
Date: 23 MAY 2025

Drawn By: AKASH
Checked By: RMI

Project No.: DIR-INVAC-001
Revision No.: 02

Orientation: N

Attachment: [List of attachments]

| | |
|----|------|
| 1 | 4700 |
| 2 | 1875 |
| 3 | 1200 |
| 4 | 500 |
| 5 | 1000 |
| 6 | 1400 |
| 7 | 2120 |
| 8 | 880 |
| 9 | 2000 |
| 10 | 940 |
| 11 | 3110 |
| 12 | 410 |
| 13 | 1340 |
| 14 | 875 |
| 15 | 1305 |
| 16 | 2645 |
| 17 | 875 |
| 18 | 3250 |
| 19 | 1000 |
| 20 | 800 |
| 21 | 900 |
| 22 | 1900 |
| 23 | 1250 |
| 24 | 750 |
| 25 | 1750 |
| 26 | 100 |
| 27 | 1900 |
| 28 | 500 |
| 29 | 950 |
| 30 | 1550 |
| 31 | 1150 |
| 32 | 1000 |
| 33 | 2801 |
| 34 | 899 |
| 35 | |

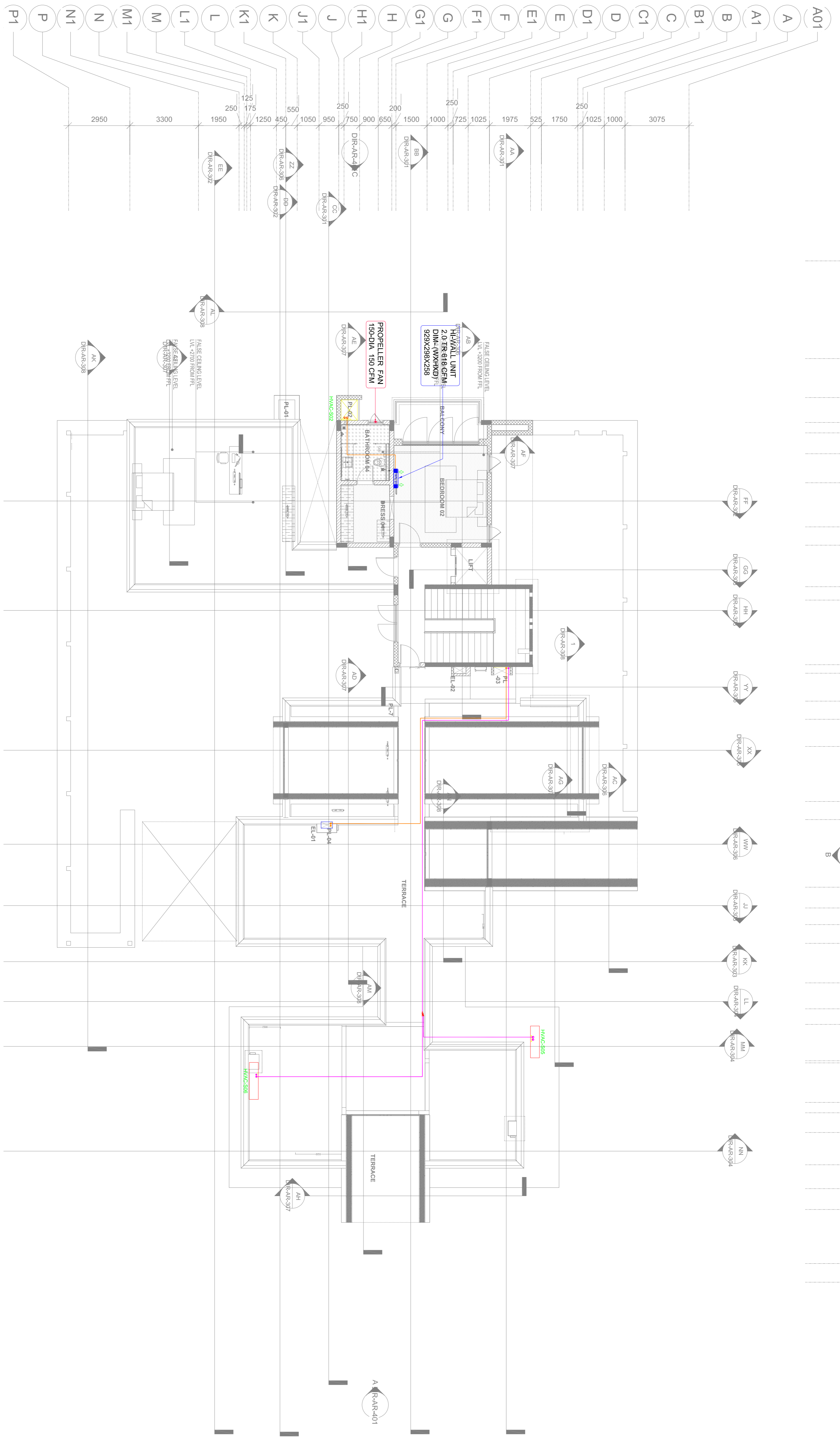

DUCT SPECIFICATION

- 26 GAUGE - 1-750 mm TDF
- 24 GAUGE - 751-1050 mm TDF
- 22 GAUGE - 1051-1200 mm TDF
- 20 GAUGE - 1201-2100 mm TDF

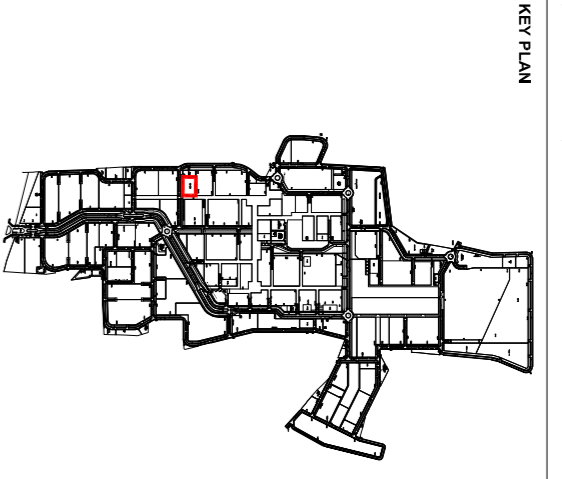
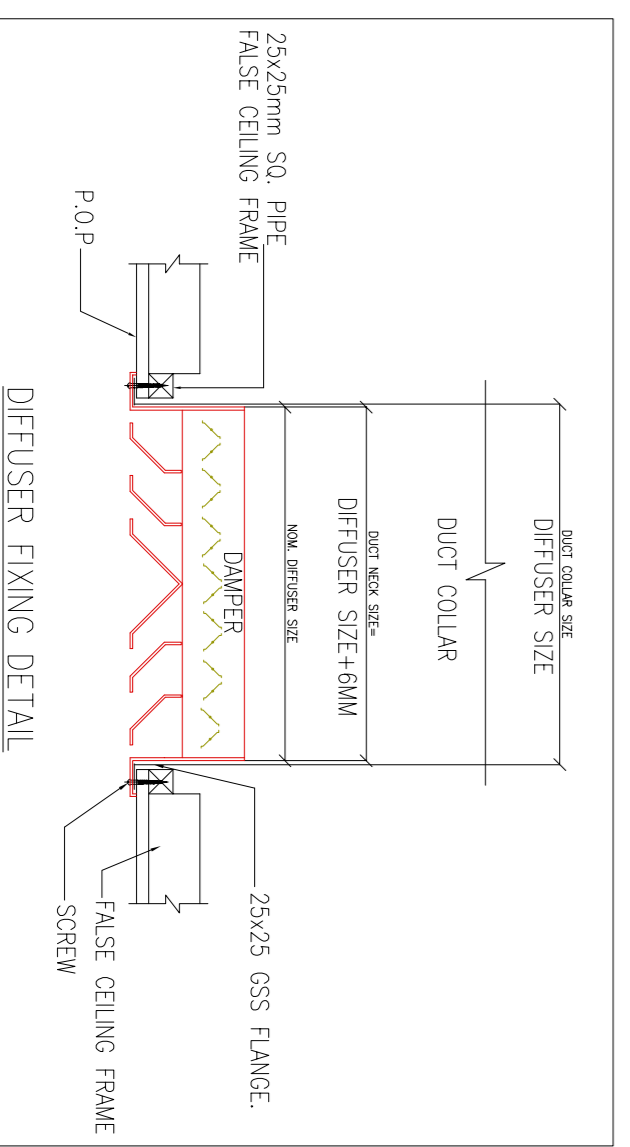
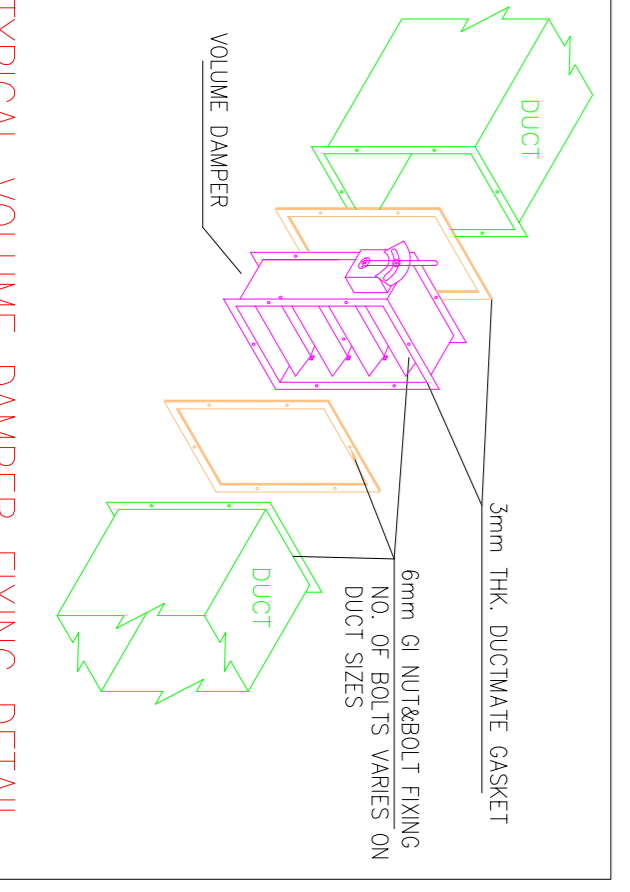
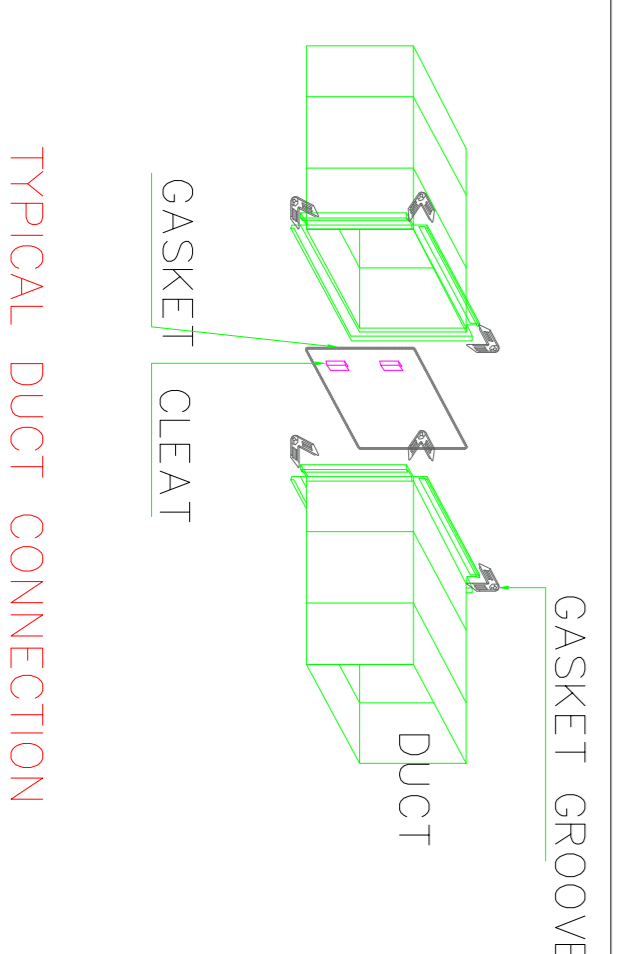

NOTES

1. All dimensions are in millimeters unless stated otherwise.
2. All work shall be in accordance with the Australian Standards AS/NZS 1546 and AS/NZS 1547.
3. The contractor shall be responsible for obtaining all necessary permits and approvals for the installation of the ductwork.
4. The ductwork shall be installed in accordance with the manufacturer's instructions and the relevant Australian Standards.
5. The ductwork shall be supported by hangers and shall be adequately braced to prevent sagging.
6. The ductwork shall be painted with a suitable paint to match the surrounding environment.
7. The ductwork shall be installed in a clean and dry environment.
8. The ductwork shall be installed in a location that is accessible for maintenance.
9. The ductwork shall be installed in a location that is protected from physical damage.
10. The ductwork shall be installed in a location that is protected from fire.

NOTES
 - Dimensions are not to be scaled.
 - All Dimensions are in Millimeters unless stated otherwise.
 - All Levels are in Millimeters and relate to Datum level.
 - The contractor shall verify all dimensions, details, specifications & site conditions & shall report any error, omission and/or anomaly to the Campus Designer before commencement of work.
 - For construction purposes, the dimensions shall not be measured directly of the drawings. The drawings shall not be used for construction until they are issued for construction.
 - These drawings are to be read in co-ordination with HVAC, Electrical, Plumbing Drawings & all relevant sections of specifications.
 - All shop drawings should be provided to the Campus Designer for approval.

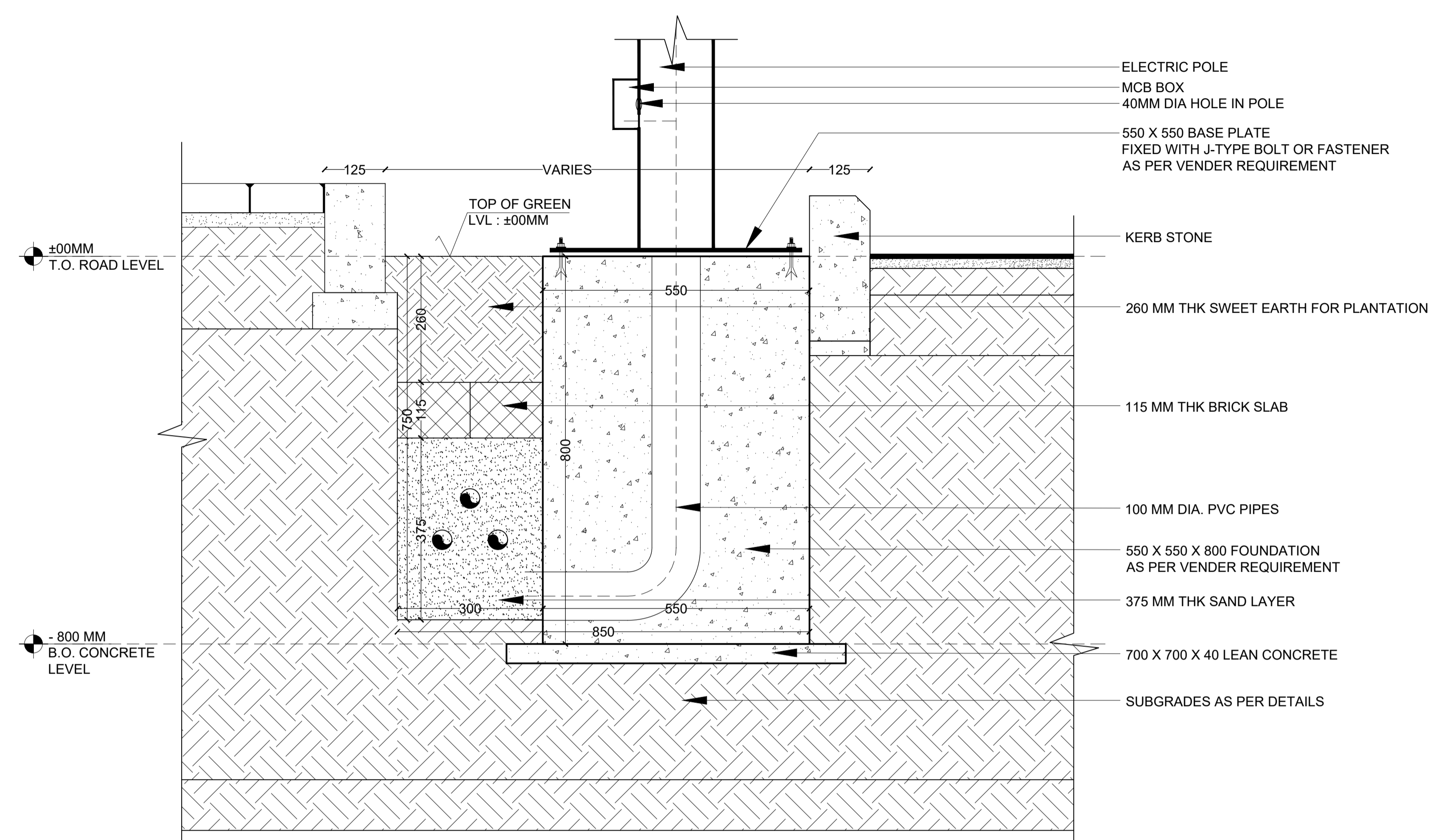

**TYPICAL MASTER PLAN DETAIL -ELECTRICAL LIGHTING POLE
 - TOPPOST LAYING DETAIL**

| ISSUES | | |
|--------|----------|-------------|
| DATE | REVISION | DESCRIPTION |
| | | |
| | | |
| | | |

1. UNLESS OTHERWISE SPECIFIED, ALL DIMENSIONS ARE IN MILLIMETERS.
 2. VENDORS TO PROVIDE SHOP DRAWINGS FOR THE APPROVAL FROM THE CAMPUS DESIGNER.

CLIENTS:
 INDIAN INSTITUTE OF TECHNOLOGY (IIT) HYDERABAD,
 Permanent Campus - Project Office,
 Kanchi Vengal, Sangamly Mandal,
 Warangal District, Andhra Pradesh - 502005

ARCHITECTS:
 ARCOF ASSOCIATES PVT. LTD.,
 A-10, Park Road, G.K. 1,
 New Delhi 110048
 Phone: 011-26442000

Architect's Signature _____ Client's Signature _____

Job Title
**INDIAN INSTITUTE OF TECHNOLOGY HYDERABAD
 INTEGRATED DIRECTOR RESIDENCE AND OFFICE COMPLEX**

Drawing Title
**TYPICAL MASTER PLAN DETAIL
 -ELECTRICAL LIGHTING POLE -
 TOPPOST LAYING DETAIL**

Document Release Type
TENDER / GOOD FOR CONSTRUCTION

Scale
VARIES

15 SEPT 2025
 Drawn by **AS** TYP-AR-MP-UTI-ELEC POLE
- TOP POST-990
 Checked by **VB** Revision No. **RD**

AUTHORITY:

DETAIL 01 - GENERAL ROUTING CONDITION

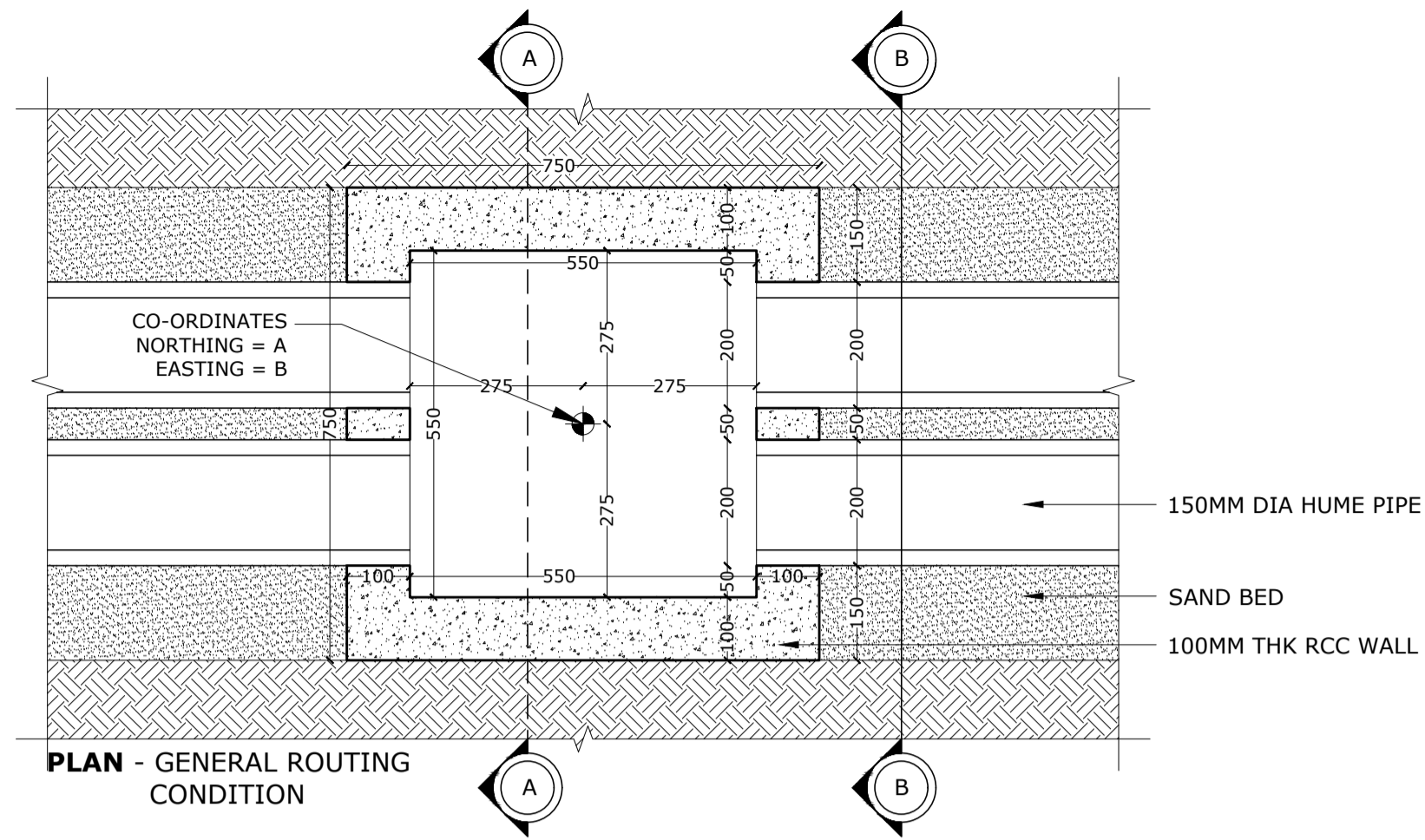

P.C.C. GRADE IS M 7.5
R.C.C. GRADE IS M 25

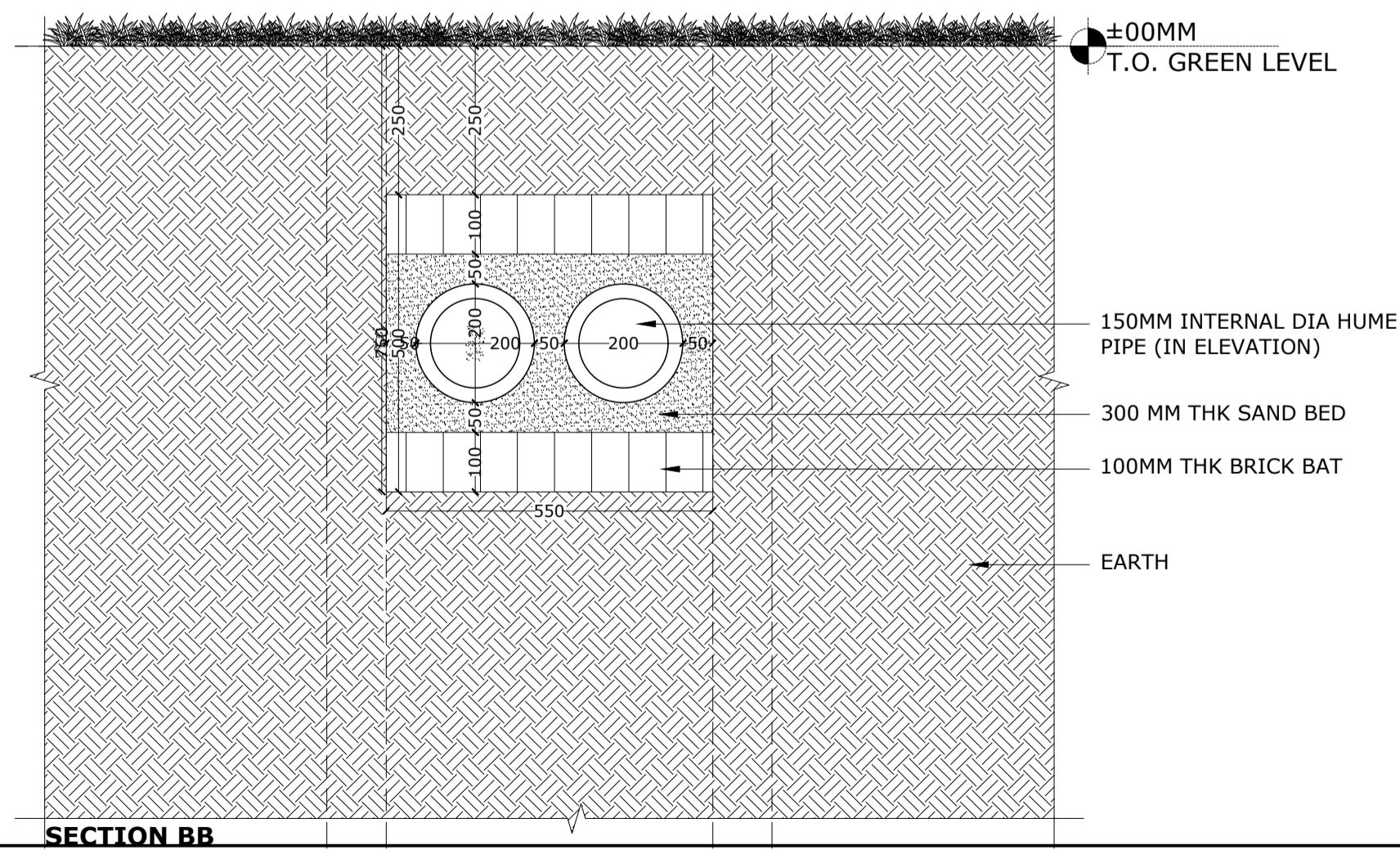
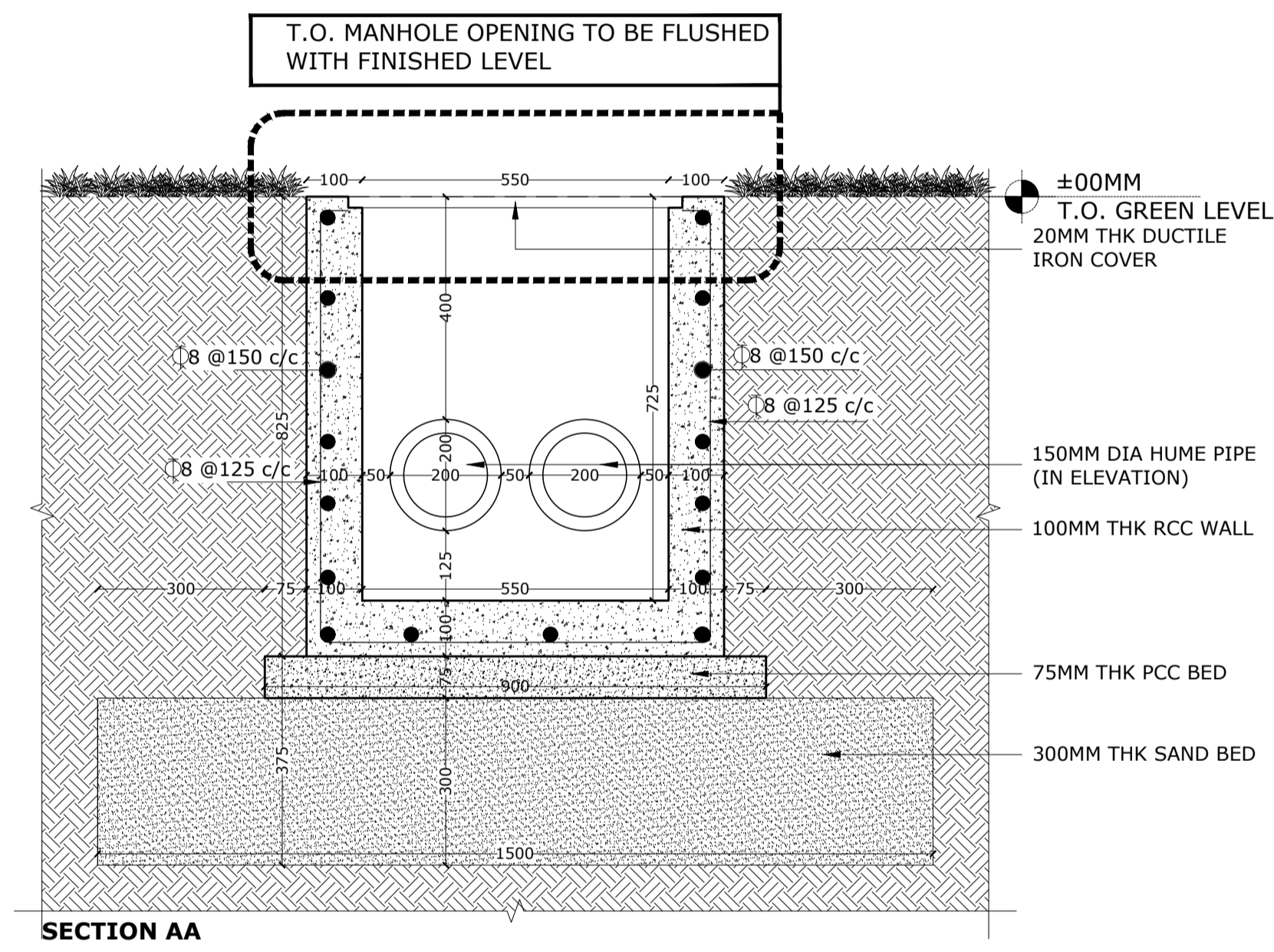

NOTE:-

- 1) HUME PIPES AND LOCATION OF SLEEVES TO BE LAID AS PER SERVICES ROUTING.
- 2) MANHOLES TO BE LOCATED AS PER ROAD MANHOLE SETTING OUT PLAN. REFER MP_RD/BVD_XXX_MH. FOR MANHOLE NUMBERING REFER MP_DET_UTI_ELV_KEY PLAN AND PART PLANS.
- 3) FOR TAP OFF LOCATIONS REFER SERVICES DRAWINGS
- 4) FOR GAS CROSSOVER LOCATIONS REFER SERVICES DRAWING
- 5) MANHOLES AND HUME PIPES WORKS TO BE BASED AS PER TENDER. ELV CABLES WILL BE LAID BY A SEPARATE VENDOR.

DETAIL 02 - TAP OFF CONDITION

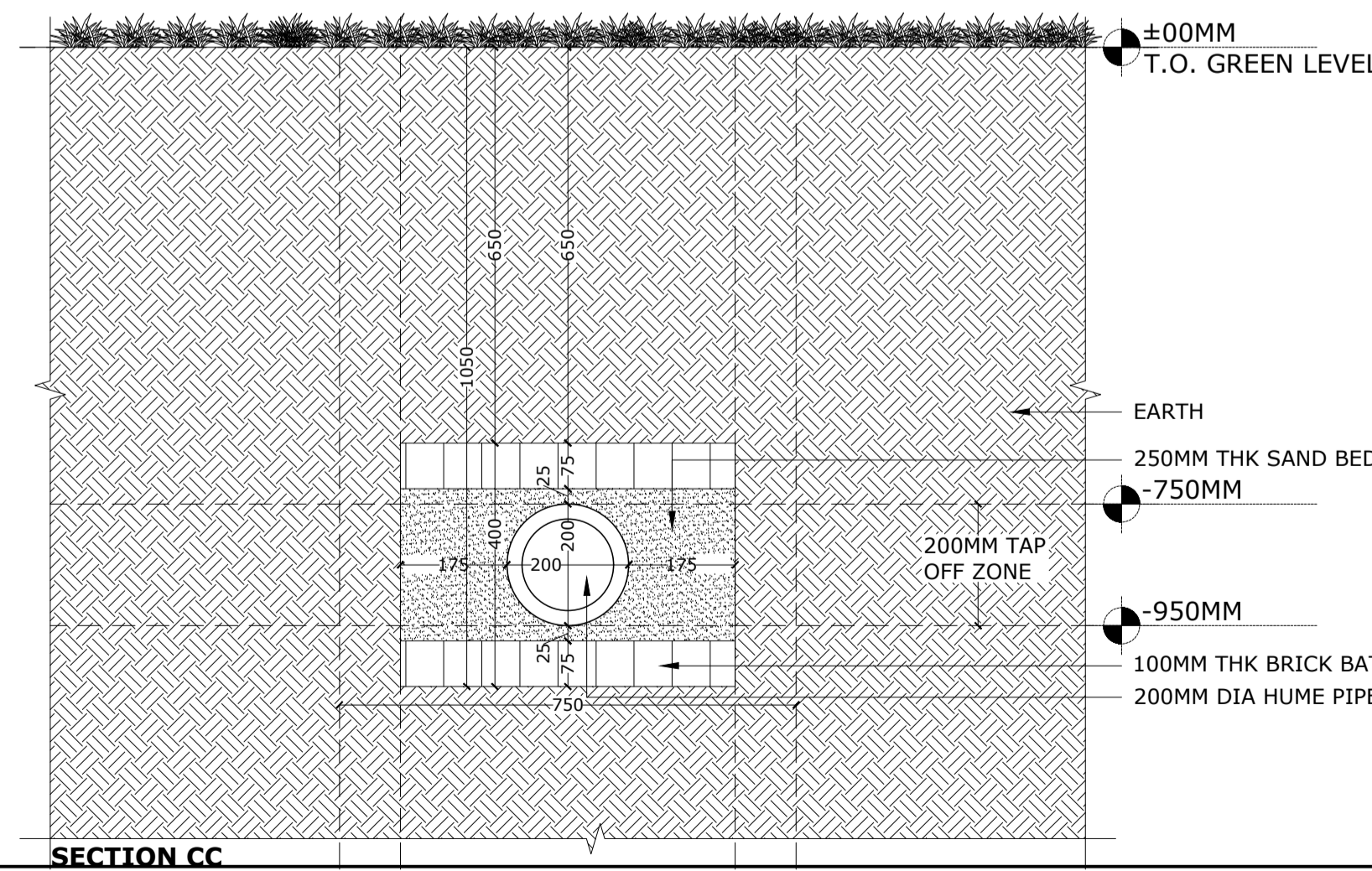
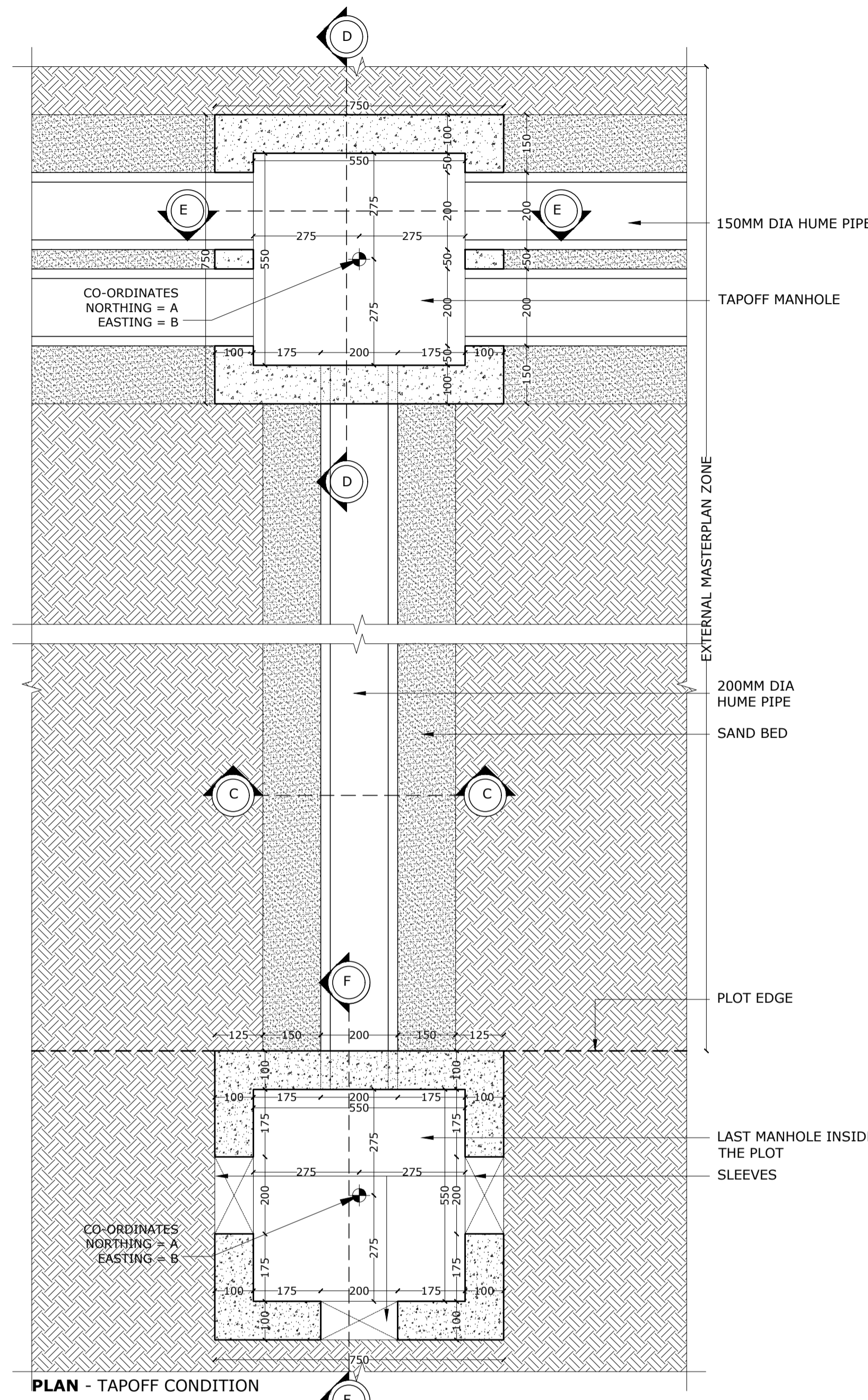

T.O. MANHOLE OPENING TO BE FLUSHED WITH FINISHED LEVEL

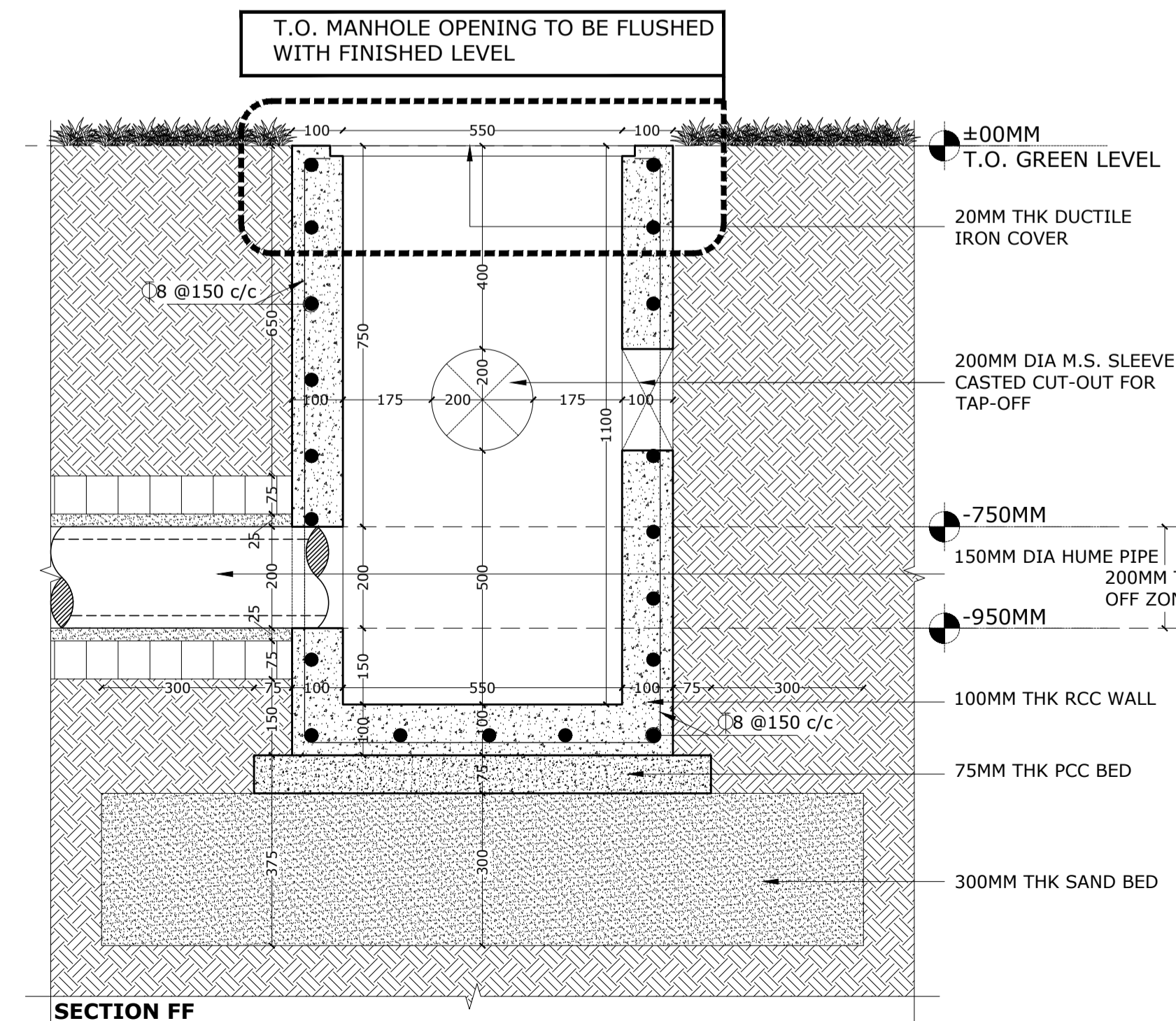
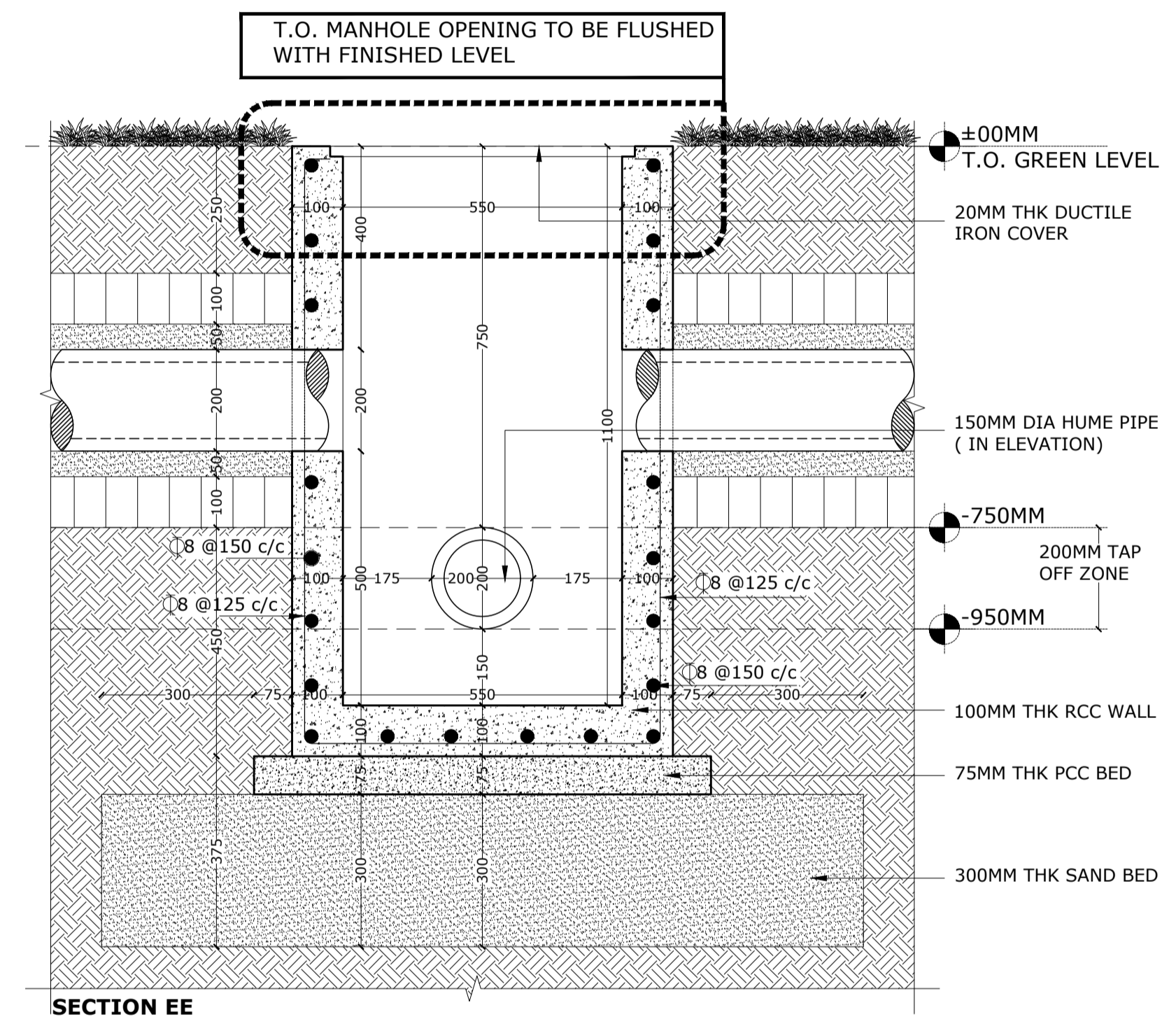
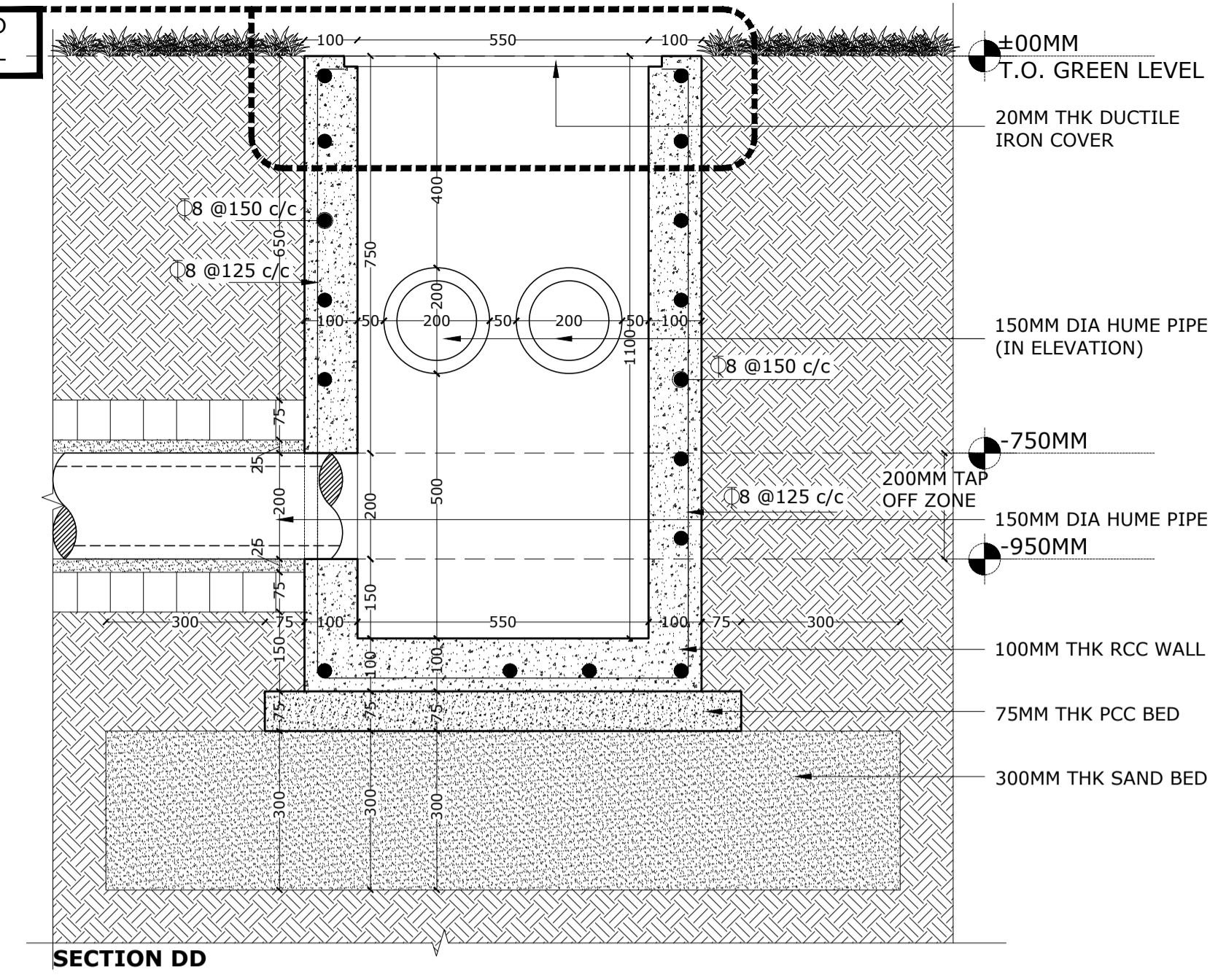

NOTES
Dimensions are not to be scaled.
All Dimensions are in Millimeters unless stated otherwise.
All Levels are in Millimeters and relate to Datum level.
The contractor shall verify all dimensions, details, specifications & site conditions & shall report any error, omission and/or anomaly to the Campus Designer before commencement of work.
For construction purposes, the dimensions shall not be measured directly of the drawings. The drawings shall not be used for construction until they are issued for construction.
These drawings are to be read in co-ordination with HVAC, Electrical, Plumbing drawings & all relevant sections of specifications.
All shop drawings should be provided to the Campus Designer for approval.

| ISSUES | | |
|--------|----------|-------------|
| DATE | REVISION | DESCRIPTION |
| | | |
| | | |
| | | |

UNAPPROVED DRAWING TO BE PROVIDED TO THE CAMPUS DESIGNER FOR APPROVAL
VENDORS TO PROVIDE SHOP DRAWINGS FOR THE APPROVAL FROM THE CAMPUS DESIGNER

CLIENTS:
INDIAN INSTITUTE OF TECHNOLOGY (IIT) HYDERABAD,
Paramveer Campus - Project Office
Kandam Hills, Hyderabad - 500025
Mobile: 98491 44444
Email: iitah@iitah.ac.in

ARCHITECTS:
ARCOP ASSOCIATES PVT. LTD.
A/10, 1st Floor, 110/55
New Delhi - 110058 (INDIA) D.K. 1
Phone: 011-26442000

Architect's Signature: _____ Client's Signature: _____

Job Title: _____
INDIAN INSTITUTE OF TECHNOLOGY HYDERABAD
INTEGRATED DIRECTOR RESIDENCE AND OFFICE COMPLEX
Drawing Title: **TYPICAL MASTER PLAN DETAIL - EXTRA LOW VOLTAGE CHAMBER**

Document Release Type: **TENDER / GOOD FOR CONSTRUCTION**

Scale: **VARIES** Drawing No: _____
15 SEPT 2025 TYP-AR-MP-UTI-ELV-886
Drawn by: **AS** Checked by: **VB**
Revision No: _____ Authority: _____

NOTES

- 1. All dimensions are in millimeters unless stated otherwise.
- 2. All work shall be in accordance with the Indian Standards & the conditions of contract.
- 3. All materials shall be of the best quality and shall be tested and approved by the Engineer before use.
- 4. All work shall be done in accordance with the approved drawings and specifications.
- 5. The Contractor shall be responsible for the safety of all workers and shall provide all necessary safety measures.
- 6. The Contractor shall be responsible for the disposal of all waste materials.
- 7. The Contractor shall be responsible for the protection of all existing structures and utilities.
- 8. The Contractor shall be responsible for the maintenance of all access roads and services.
- 9. The Contractor shall be responsible for the completion of the work within the approved time schedule.
- 10. The Contractor shall be responsible for the payment of all taxes and levies.
- 11. The Contractor shall be responsible for the insurance of all materials and equipment.
- 12. The Contractor shall be responsible for the safety of the public and shall provide all necessary safety measures.
- 13. The Contractor shall be responsible for the protection of the environment and shall provide all necessary measures.
- 14. The Contractor shall be responsible for the maintenance of all records and documents.
- 15. The Contractor shall be responsible for the completion of the work within the approved time schedule.

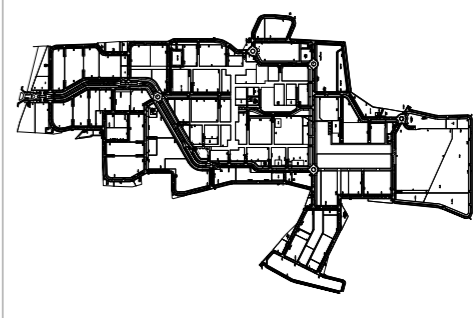

KEY PLAN

NOTE: REFER MASTER PLAN AND SITE PLAN FOR THE ABSOLUTE LEVEL OF THE DIRECTOR RESIDENCE AND THE CLUSTER AND REFER ALL SERVICES AND STRUCTURAL DRAWINGS FOR COORDINATION OF THE DIRECTOR RESIDENCE WITH THE CLUSTER AND REFER TO THE SITE PLAN FOR THE LOCATION OF THE DIRECTOR RESIDENCE IN THE CLUSTER.

HATCH LEGEND

| | |
|--|-----------------------|
| | EXPOSED CONCRETE |
| | NON EXPOSED CONCRETE |
| | CONCRETE BLOCK WORK |
| | AAC BLOCK WORK |
| | TERRACOTTA BRICK WALL |
| | 100 MM SLINK |
| | 600 MM SLINK |
| | 750 MM SLINK |
| | 900 MM SLINK |
| | 350 MM SLINK |
| | 1650 MM FILLING |

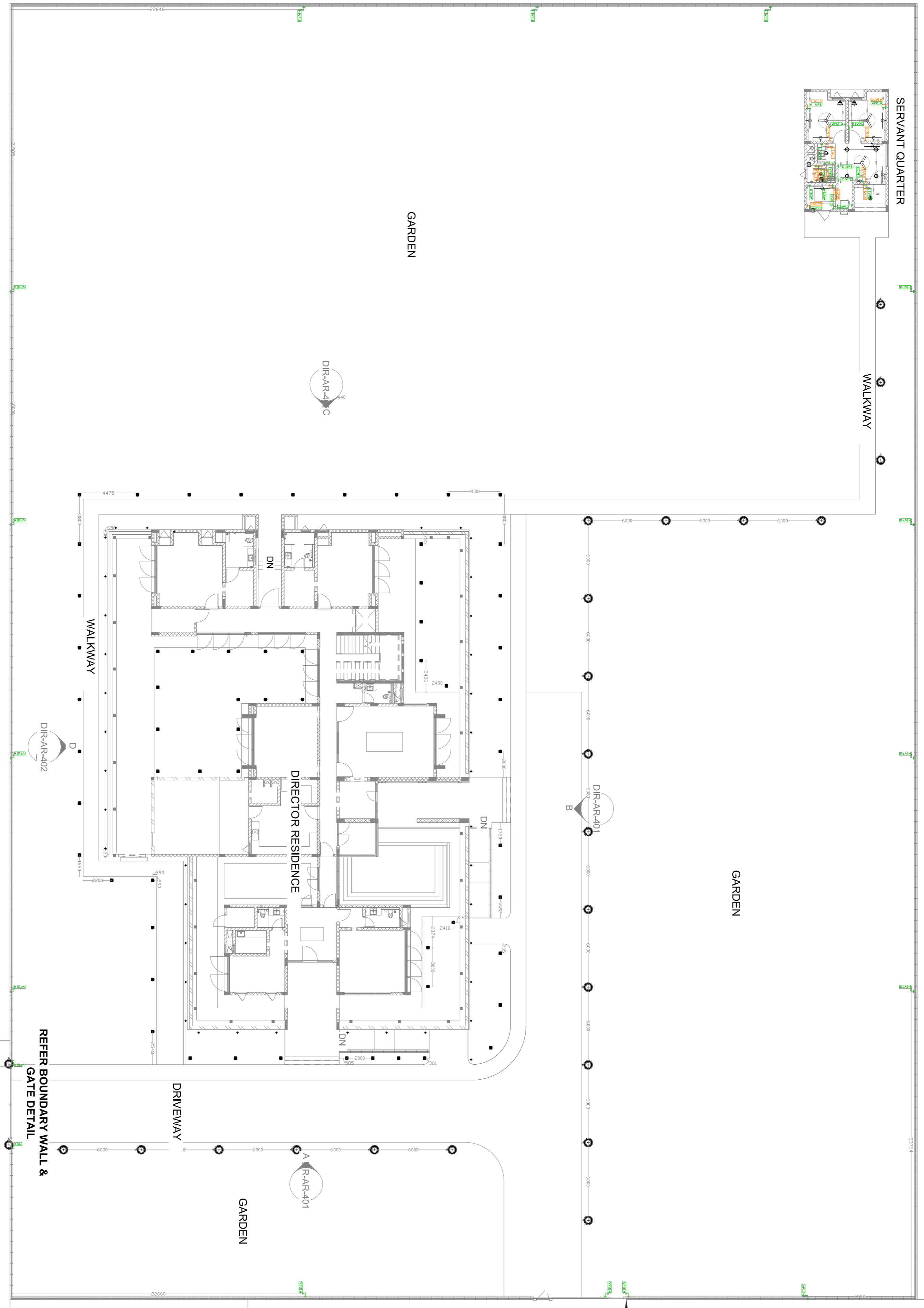

REFER BUILDING DETAIL
HATCH FROM
MAXIMUM CONCRETE
THICKNESS

REFER BOUNDARY WALL &
GATE DETAIL
WICKET GATE

REFER BOUNDARY WALL &
GATE DETAIL
ENTRY GATE

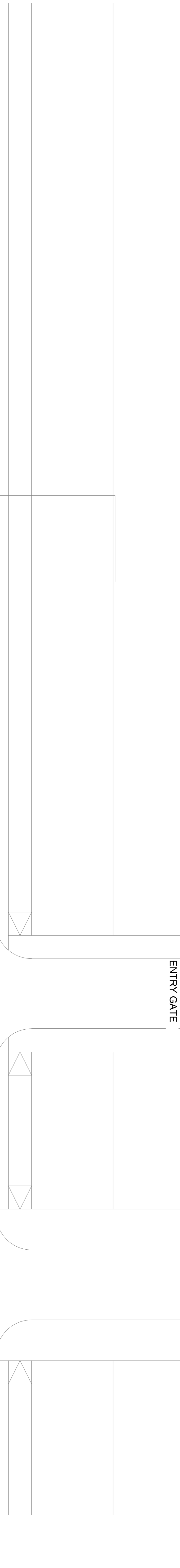

00 SITE PLAN

ABSOLUTE LEVEL - NOTE: REFER ABSOLUTE LEVEL AS PER MASTER PLAN

1 : 200

| | | | |
|-----------------------|-----------------------|--|--------------------|
| Document Release Type | | TENDER / GOOD FOR CONSTRUCTION | |
| Job No. | 2025055 | Client's Signature | Client's Signature |
| Scale | 1 : 200 | 28th FEB | |
| Date | 26 MAY 2025 | INDIAN INSTITUTE OF TECHNOLOGY HYDERABAD | |
| Drawn By | DIR-AR-120, RCP & ARE | INTEGRATED DIRECTOR RESIDENCE AND OFFICE COMPLEX | |
| Checked By | SM | Drawing No. | |
| Approved By | SM | Revision No. | |
| Attachment: | | SITE PLAN - RCP & ARCHITECTURAL ELECTRICAL PLAN | |

01_GROUND FLOOR
1 : 100



NOTES

- 1. All dimensions are in mm unless otherwise stated.
- 2. All work shall be in accordance with the Indian Standards and specifications.
- 3. All materials shall be of good quality and shall be approved by the Engineer-in-Charge.
- 4. All work shall be done in accordance with the approved drawings and specifications.
- 5. All work shall be done in accordance with the approved drawings and specifications.
- 6. All work shall be done in accordance with the approved drawings and specifications.
- 7. All work shall be done in accordance with the approved drawings and specifications.
- 8. All work shall be done in accordance with the approved drawings and specifications.
- 9. All work shall be done in accordance with the approved drawings and specifications.
- 10. All work shall be done in accordance with the approved drawings and specifications.

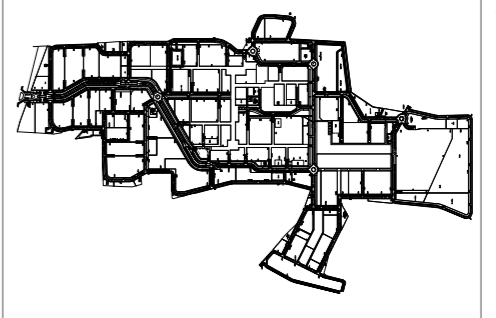

NOTE: REFER MASTER PLAN AND SITE PLAN FOR THE ABSOLUTE LEVEL OF THE BUILDING.

| HATCH LEGEND | DESCRIPTION |
|-----------------|-----------------------|
| [Hatch Pattern] | EXPOSED CONCRETE |
| [Hatch Pattern] | NON EXPOSED CONCRETE |
| [Hatch Pattern] | CONCRETE BLOCK WORK |
| [Hatch Pattern] | AAC BLOCK WORK |
| [Hatch Pattern] | TERRACOTTA BRICK WALL |
| [Hatch Pattern] | 100 MM SLUNK |
| [Hatch Pattern] | 600 MM SLUNK |
| [Hatch Pattern] | 750 MM SLUNK |
| [Hatch Pattern] | 900 MM SLUNK |
| [Hatch Pattern] | 350 MM SLUNK |
| [Hatch Pattern] | 1500 MM TILLING |

STAMP

ISSUES

| REVISION | DESCRIPTION | DATE |
|----------|-------------|------|
| | | |

CLIENTS:
INDIAN INSTITUTE OF TECHNOLOGY HYDERABAD
INTEGRATED DIRECTOR RESIDENCE AND OFFICE COMPLEX

CLIENT'S SIGNATURE: _____

ARCHITECT'S SIGNATURE: _____

DATE: 23 MAY 2025

SCALE: 1:100

PROJECT NAME: GROUND FLOOR - RCP & ARCHITECTURAL ELECTRICAL PLAN

PROJECT NO.: DIR-AR-201-RCP & ARE

DESIGNED BY: SAJ

CHECKED BY: SAJ

APPROVED BY: SAJ

1- All quantities are in mtr & kg unless otherwise specified.
2- All works are to be done as per the approved drawings.
3- All materials to be used shall be of good quality & approved by the Engineer.
4- All work to be done shall be in accordance with the approved drawings & specifications.
5- All work to be done shall be in accordance with the approved drawings & specifications.
6- All work to be done shall be in accordance with the approved drawings & specifications.
7- All work to be done shall be in accordance with the approved drawings & specifications.
8- All work to be done shall be in accordance with the approved drawings & specifications.
9- All work to be done shall be in accordance with the approved drawings & specifications.
10- All work to be done shall be in accordance with the approved drawings & specifications.

DATA MODULES

| MODULE SIZE | NAME | | | | | | | |
|-------------|--|---|--|--|--|--|--|--|
| 1 | DATA (CAT 6 from IT Rack) | 1 | | | | | | |
| 1 | IP TEL (CAT 6 from IT Rack) | 1 | | | | | | |
| 1 | IPTV (CAT 6 from IT Rack) | 1 | | | | | | |
| 1 | DTH TV (COAXIAL Convert from IT Rack) | 1 | | | | | | |
| 1 | WIFI (POE from IT Rack) | 1 | | | | | | |
| 1 | CCTV (POE from IT Rack) | 1 | | | | | | |
| 1 | HDMI CABLE(LED SCREEN TO CONF TABLE) | 1 | | | | | | |

| | | | | | | | | |
|---|--------|---|---|---|---|---|---|---|
| 2 | WD3 | 1 | 1 | | | | | |
| 2 | WD6 | | | 1 | | | | |
| 1 | WD7 | | | | 1 | | | |
| 1 | WD8 | | | | | 1 | | |
| 1 | WD10 | | | | | | 1 | |
| 1 | FWD10Y | | | | | | | 1 |
| 1 | CD1 | | | | | | 1 | |
| 3 | FD2 | 2 | 1 | | | | | |
| 6 | FD4 | 4 | 2 | | | | | |
| 2 | FD8 | 1 | 1 | | | | | |
| 1 | WD16 | | 1 | | | | | |

LIGHTING MODULES

| MODULE SIZE | NAME | | | | | | | |
|-------------|----------------------------------|---|---|---|---|---|---|---|
| 1 | LIGHT SWITCH | 1 | | | | | | |
| 1 | LIGHT SECOND SWTICH PT (2 WAY) | 1 | | | | | | |
| 3 | FAN (WITH 2 MODULE REGULATOR) | 3 | | | | | | |
| 1 | FAN SECOND SWTICH PT (2 WAY) | 1 | | | | | | |
| 2 | BELL SWITCH (2 MODULE) | 2 | | | | | | |
| 2 | TOILET EXHAUST COMMON SWITCH | 2 | | | | | | |
| 2 | TOILET EXHAUST SOCKET | 2 | | | | | | |
| 1 | SPARE | 1 | | | | | | |
| | | | | | | | | |
| 2 | WL1 | 1 | | | | | | 1 |
| 2 | WL2 | 2 | | | | | | |
| 4 | WL3 | 3 | | | | | | |
| 4 | WL4 | 4 | | | | | | 1 |
| 6 | WL5 | 5 | | | | | | 1 |
| 6 | WL6 | 6 | | | | | | |
| 8 | WL7 | 8 | | | | | | |
| 6 | WL8 | | 2 | | | | | |
| 4 | WL14 | 1 | | 1 | | | | |
| 6 | WL15 | 2 | | 1 | | | | 1 |
| 6 | WL16 | 3 | | 1 | | | | |
| 8 | WL17 | 4 | | 1 | | | | 1 |
| 8 | WL18 | 1 | | 2 | | | | 1 |
| 8 | WL19 | 2 | | 2 | | | | |
| 3 | WL20 | | | | 1 | | | 1 |
| 2 | WL21 | | | | | 1 | | 1 |
| 2 | WL21X | | | | | | 1 | |
| 8 | WL35 | 3 | 1 | 1 | | | | 1 |
| 4 | WL36 | 1 | 1 | | 1 | | | 1 |
| 4 | WL37 | 3 | 1 | | | | | |
| 6 | WL39 | 1 | 1 | 1 | | | | 1 |
| 6 | WL42 | 4 | 1 | | | | | 1 |
| 6 | WL43 | 4 | 2 | | | | | |
| 6 | WL44 | 5 | 1 | | | | | |
| 6 | WL45 | 1 | 2 | | | | | 1 |

| REVISION | DESCRIPTION | DATE |
|----------|-------------|------|
| | | |
| | | |
| | | |
| | | |

CLIENTS :
STATE OF TELANGANA
DEPARTMENT OF TECHNICAL EDUCATION
HYDRABAD
STATE OF TELANGANA
DEPARTMENT OF TECHNICAL EDUCATION
HYDRABAD

CLIENTS :
STATE OF TELANGANA
DEPARTMENT OF TECHNICAL EDUCATION
HYDRABAD
STATE OF TELANGANA
DEPARTMENT OF TECHNICAL EDUCATION
HYDRABAD

MASTER SCHEDULE OF ELECTRICAL MODULE

Document Revision Type
 Job No. 2025/85
 Scale 1:100
 Date 25 MAY 2025
 Drawing No. BLD-AR-008
 Revision No. 02

Author's Signature _____
 Client's Signature _____

Job No. 2025/85
 Scale 1:100
 Date 25 MAY 2025
 Drawing No. BLD-AR-008
 Revision No. 02

Author's Signature _____
 Client's Signature _____

| TAG | HEIGHTS |
|-----|---------|
| A | 300 |
| B | 850 |
| C | 1100 |
| D | 1500 |
| E | 2200 |
| F | 2800 |
| G | 3900 |
| H | 600 |
| J | 2000 |
| K | 2600 |

| FIXTURE LEGEND | | | |
|-----------------------------------|--------|--|-----------------------------------|
| BLOCK NAME | SYMBOL | DESCRIPTION | HEIGHT(BTM OF FIXTURE) / LOCATION |
| 3 CEILING MOUNTED_FAN | | FAN | LVL+3100 FROM F.F.L |
| 3_L_WALL_2 | | WALL MOUNTED TUBE LIGHT (H) | LVL+2600MM FROM F.F |
| 3_L_WALL_3 | | WALL MOUNTED TOILET(ABOVE MIRROR) | LVL+2050MM FROM F.F |
| 3_L_WALL_4 | | WALL MOUNTED BULK HEAD(SHAFT) | LVL+2600MM FROM F.F |
| 3_L_WALL_5 | | WALL MOUNTED(MOON LED-EXTERNAL) | LVL+2820MM FROM LANDING F.F |
| 3_L_RECESSED_1 | | FALSE CEILING- ROUND(RECESSED) | ON FALSE CEILING (AS/SEC) |
| 3_L_RECESSED_1_EMERGENCY | | FALSE CEILING- ROUND (RECESSED-EMERGENCY) | ON FALSE CEILING (AS/SEC) |
| 3_L_SURFACE_21 | | LINEAR SURFACE LIGHT | ON FALSE CEILING (AS/SEC) |
| 3_L_RECESSED_2 | | FALSE CEILING- SQUARE (RECESSED) | ON FALSE CEILING (AS/SEC) |
| 3_L_WALL FLOODLIGHT | | FLOOD LIGHT | ON TERRACE PARAPET LEVEL |
| 3_L_WALL_7 | | WALL MOUNTED BRACKET LIGHT | LVL+2100MM FROM F.F OR |
| 3_L_SURFACE_11 | | 12W SURFACE MOUNTED GARNET MOONLIGHT | CEILING |
| 3_L_SURFACE_11_EMERGENCY | | 12W SURFACE MOUNTED GARNET MOONLIGHT (EMERGENCY) | CEILING |
| 3_L_SURFACE_1 | | SURFACE MOUNTED(MOON LED-EXTERNAL) | CEILING |
| 3_L_SURFACE_1_EMERGENCY | | SURFACE MOUNTED(MOON LED-EXTERNAL EMERGENCY) | CEILING |
| 3_L_COVE LIGHT_18 | | FALSE CEILING/UNDER OVERHEAD COUNTER | CEILING/ABOVE KITCHEN COUNTER TOP |
| 3_L_CHANDELIER_17 | | CEILING SUSPENDED LIGHT | CEILING |
| 3_L_SURFACE_20 | | LINEAR SURFACE LIGHT | CEILING |
| 3_L_WALL_1 | | WALL MOUNTED TUBE LIGHT | LVL+2600MM FROM F.F |
| 3_L_SUSPENDED_19 | | CEILING SUSPENDED LIGHT FOYER(DOUBLE HEIGHT) | LVL+4300MM FROM F.F |
| 3_L_SURFACE_18 | | SURFACE MOUNTED (IP-65) | CEILING |
| Z_BUZZER | | DOOR BELL (BUZZER) | LVL+2600MM FROM F.F |
| 3_WALL_FOOTLIGHT | | FOOTLIGHT | - |
| 3_L_STEP LIGHT | | STEP LIGHT | - |
| 3_L_PATH LIGHTER | | LANDSCAPE PATH LIGHTER | FLOOR |
| 3_L_WALL HIGH LIGHTER | | JALI WALL HIGH LIGHTER | FLOOR |
| 3_RACEWAY | | RACEWAY | FLOOR |
| 3_WALL MOUNTED_WIFI | | WALL MOUNTED WIFI ROUTER | LVL+ 2600MM FROM F.F |
| 3_WALL MOUNTED_CCTV | | WALL MOUNTED CCTV ROUTER | LVL+ 2600MM FROM F.F |
| 3_CEILING MOUNTED_CCTV | | CEILING MOUNTED CCTV | CEILING |
| 3_JUNCTION BOX | | FLOOR JUNCTION BOX | - |
| 3_AC_VRV_INDOOR | | VRV AC INDOOR WALL UNIT | AC BOTTOM LVL+ 2750MM FROM F.F |
| 3_HVAC_TRAP DOOR | | VRV AC INDOOR CEILING UNIT | CEILING |
| 3_MODULE | | WALL MODULE | AS/HEIGHT LEGEND |
| RCP_CEILING MODULE | | CEILING MODULE | CEILING |
| FLR_FLOORING MODULE | | FLOOR MODULE | FLOOR |
| 3_EXHAUST FAN | | EXHAUST FAN | - |
| 3_GEYSER | | GEYSER | HEIGHT : 600MM DIA: 400MM |
| 3_FIXTURE_PANIC BUTTON | | PANIC BUTTON FOR SPECIALLY ABLED IN TOILETS | LVL+850 MM FROM F.F.L |
| 1_TOP POST LIGHT | | TOP POST LIGHT @ 6M DISTANCE | TOP POST HEIGHT : 3MTRS |
| 3_L_TREE | | TREE / BUSH UPLIGHTER/FOCUS LIGHT | FLOOR |
| 3_FIXTURE_ALARM & LIGHT INDICATOR | | ALARM & LIGHT INDICATOR FOR PANIC BUTTON IN CORRIDOR | LVL+2200MM FROM F.F.L |

FALSE CEILING LEGEND

| SYMBOL | DESCRIPTION | SYMBOL | DESCRIPTION |
|--------|-------------|--------|---------------|
| | C6 | | C17 |
| | C21 | | STARTING TILE |

NOTES

- Dimensions are not to be scaled.
- All dimensions are in millimeters unless stated otherwise.
- All levels are in millimeters and relate to given datum level.
- The contractor shall verify all dimensions, details, specifications & site conditions & shall report any error, omission and/or anomaly to the campus designer before commencement of work.
- For construction purposes, the dimensions shall not be measured directly of the drawings, the drawings shall not be used for construction until they are issued for construction.
- Drawings are to be read in co-ordination with hvac, electrical, plumbing, it drawings & all relevant sections of specifications.
- All shop drawings should be provided to the campus designer for approval.
- Provide drip course on the bottom of all external horizontal edges and surfaces (concrete, stone, plaster, etc) as per dimensions and shape provided in detail.
- Shuttering pattern drawing to be provided to the campus designer for approval.
- Vendors to provide shop drawings for the approval from the campus designer.
- Shuttering elevation shop drawing to reflect the not locations, the rods should be equally spaced and aligned according to the shuttering pattern. consider: te rod pvc dia =18mm and pvc cone dia=20mm

| ISSUES | | |
|----------|-------------|--------|
| REVISION | DESCRIPTION | DATE |
| 1 | Revision 1 | Date 1 |
| | | |
| | | |
| | | |
| | | |
| | | |
| | | |
| | | |
| | | |
| | | |

IMPORTANT DRAWINGS TO BE PROVIDED TO THE CAMPUS DESIGNER FOR APPROVAL:
 1. VENDORS TO PROVIDE SHOP DRAWINGS FOR THE APPROVAL FROM THE CAMPUS DESIGNER

CLIENTS :
 INDIAN INSTITUTE OF TECHNOLOGY (IIT) HYDERABAD
 Permanent Campus - Project Office
 Kanchi Village, Sangareddy District
 Medak, Dist.H. Andhra Pradesh - 502385

CAMPUS DESIGNER:
 ANOOP ASSOCIATES PVT LTD
 A-16 Pampach Enclave, G.K.1
 New Delhi - 110046
 Phone : 011-28422988

Architect's Signature _____ Client's Signature _____

JOB TITLE
INDIAN INSTITUTE OF TECHNOLOGY HYDERABAD
INTEGRATED DIRECTOR RESIDENCE AND OFFICE COMPLEX

Drawing Title
MASTER SCHEDULE OF ELECTRICAL & RCP FIXTURE

| Document Release Type | |
|-------------------------------|----------------------|
| TENDER/ GOOD FOR CONSTRUCTION | |
| Job No. 2025/05 | NORTH |
| Scale 1 : 100 | |
| 15 SEPT 2025 | Drawn No. BLD-AR-007 |
| Checked by KK | Revision No. RO |
| Checked by SS | |
| AUTHORITY : | |

LIGHTING FIXTURE SCHEDULE

| S.NO. | FIXTURE TYPE | LOCATION | SYMBOL | CAD BLOCK NAME | MAKE / MODEL NO. | SPECIFICATION | COST | REFERENCE IMAGE |
|-------|-----------------------|---|--------|--------------------------|---|---|------|-----------------|
| 1 | SURFACE | CEILING TUBE LIGHT | | 3_L_SURFACE_20 | LL24 251 XXX 57 HE1 | Construction Material: Aluminum Anodized Extruded 1) Dimensions (mm): 1190 X 40 X 45 2) System Lumen O/P: > 2000lm 3) CCT: 5700K 4) Minimum System Efficacy: >150lm/w 5) Mounting Type: Surface/Wall 6) CRI > 80 7) THD < 10% 8) IP Rating: IP40 9) IK: 06 10) Internal Surge Protection 4kV | 2720 | |
| 2 | WALL MOUNTED | WALL TUBELIGHT | | 3_L_WALL_1 | LL20 211 XX 65AL NE | Construction Material: Aluminum Anodized Extrud 1) Dimensions (mm): 1134 X 23.5X 37.5 2) System Lumen O/P: > 2000lm 3) CCT: 6500K 4) Minimum System Efficacy: >100lm/w 5) Mounting Type: Surface/Wall 6) CRI > 80 7) THD < 20% 8) IP Rating: IP20 9) Internal Surge Protection 4kV | 550 | |
| 3 | WALL MOUNTED | WALL TUBELIGHT | | 3_L_WALL_1_EMERGENCY | LL20 211 XX 65AL NE | Construction Material: Aluminum Anodized Extrud 1) Dimensions (mm): 1134 X 23.5X 37.5 2) System Lumen O/P: > 2000lm 3) CCT: 6500K 4) Minimum System Efficacy: >100lm/w 5) Mounting Type: Surface/Wall 6) CRI > 80 7) THD < 20% 8) IP Rating: IP20 9) Internal Surge Protection 4kV | 550 | |
| 4 | WALL MOUNTED | WALL TUBELIGHT(H) | | 3_L_WALL_2 | LL24 261 XXX 57 HE1 | Construction Material: Aluminum Anodized Extruded 1) Dimensions (mm): 1190 X 40 X 45 2) System Lumen O/P: > 2000lm 3) CCT: 5700K 4) Minimum System Efficacy: >150lm/w 5) Mounting Type: Surface/Wall 6) CRI > 80 7) THD < 10% 8) IP Rating: IP40 9) IK: 06 10) Internal Surge Protection 4kV | 2850 | |
| 5 | FALSE CEILING | CEILING TUBE LIGHT | | 3_L_SUSPENDED_21 | | | | |
| 6 | WALL MOUNTED | TOILET (ABOVE MIRROR) | | 3_L_WALL_3 | LL20 111 X65AL SB | Construction Material: Aluminum Extruded 1) Dimensions (mm): 598 X 22 X 36.5 2) System Lumen O/P: > 1150lm 3) CCT: 6500K 4) Minimum System Efficacy: >115lm/w 5) Mounting Type: Surface/Wall 6) CRI > 80 7) THD < 10% 8) IP Rating: IP20 9) Wattage: 10W 10) Internal Surge Protection 2.5kV | 820 | |
| 7 | WALL MOUNTED | SHAFT | | 3_L_WALL_4 | LLW7 141 XXX 57 G1 | Construction Material: PDC 1) Dimensions (mm): 182 X 12 X 64 2) System Lumen O/P: > 1000LM 3) CCT: 5700K 4) Minimum System Efficacy: >100lm/w 5) Mounting Type: Surface Mounted 6) CRI > 80 7) THD < 10% 8) IP Rating: IP65 9) IK: 10 | 1310 | |
| 8 | WALL MOUNTED | EXTERNAL WALL & CEILING BALCONY, TERRACE, STAIRCASE | | 3_L_WALL_5 | LLW21 111 XXX 57 XX | Construction Material: Aluminum Die Cast 1) Dimensions (mm): 270mm Dia 2) System Lumen O/P: > 1000LM 3) CCT: 5700K 4) Minimum System Efficacy: >100lm/w 5) Mounting Type: Surface/Wall mounted 6) CRI > 80 7) THD < 10% 8) IP Rating: IP65 9) Internal Surge Protection 2.5kV 10) Wattage: 10W | 1980 | |
| 9 | SURFACE | EXTERNAL WALL & CEILING BALCONY, TERRACE, STAIRCASE | | 3_L_SURFACE_1 | LLW21 111 XXX 57 XX | Construction Material: Aluminum Die Cast 1) Dimensions (mm): 270mm Dia 2) System Lumen O/P: > 1000LM 3) CCT: 5700K 4) Minimum System Efficacy: >100lm/w 5) Mounting Type: Surface/Wall mounted 6) CRI > 80 7) THD < 10% 8) IP Rating: IP65 9) Internal Surge Protection 2.5kV 10) Wattage: 10W | 1980 | |
| 10 | SURFACE | EXTERNAL CEILING | | 3_L_SURFACE_16 | LL08 151 060 40 SM | Construction Material: Extruded Aluminium 1) Dimensions (mm): 100mm Dia x 200mm (H) 2) System Lumen O/P: > 1350LM 3) CCT: 3000K/4000K 4) Minimum System Efficacy: >80 lm/w 5) Mounting Type: Surface ceiling 6) CRI > 80 7) IP Rating: IP65 8) Internal Surge Protection 2kV 9) Wattage: 10W | 8250 | |
| 11 | FALSE CEILING(ROUND) | INTERNAL | | 3_L_RECESSED_1 | Wipro LD56 381 XXX 57IR | Construction Material: PDC Aluminium. 1) Dimensions (mm): Ø 135mm Dia 2) System Lumen O/P: > 2000LM 3) CCT: 5700K 4) Minimum System Efficacy: >100lm/w 5) Mounting Type: Recessed mounted. 6) CRI > 80 7) THD < 20% 8) IP Rating: IP20 9) Wattage: 32W | 4950 | |
| 12 | FALSE CEILING(ROUND) | INTERNAL_EMERGENCY | | 3_L_RECESSED_1 EMERGENCY | Wipro LD56 381 XXX 57IR | Construction Material: PDC Aluminium. 1) Dimensions (mm): Ø 135mm Dia 2) System Lumen O/P: > 2000LM 3) CCT: 5700K 4) Minimum System Efficacy: >100lm/w 5) Mounting Type: Recessed mounted. 6) CRI > 80 7) THD < 20% 8) IP Rating: IP20 9) Wattage: 32W | 4950 | |
| 13 | FALSE CEILING(SQUARE) | INTERNAL | | 3_L_RECESSED2 | Wipro LD81 281 XXX 60 XX (High LED Slim SQ) | Construction Material: Aluminium die cast. 1) Dimensions (mm): 178 X 178 Cut-Out Dimensions 2) System Lumen O/P: > 1500lm 3) CCT: 6500K 4) Minimum System Efficacy: >100lm/w 5) Mounting Type: Recessed Mounted 6) CRI > 80 7) THD < 20% 8) IP Rating: IP20 9) Wattage: 15W | 1100 | |
| 14 | GROUND | TREE / BUSH UPLIGHTER/FOCUS LIGHT | | 3_L_TREE | Wipro LF05 600 655 27IR | Construction Material: PDC Aluminium. 1) Dimensions (mm): 115mm Dia X 158mm length 2) System Lumen O/P: > 600lm 3) CCT: 2700K 4) Minimum System Efficacy: >275lm/w 5) Mounting Type: Surface 6) CRI > 70 7) THD < 25% 8) IP Rating: IP67 9) Wattage: 8W | 4712 | |

Site: BLD AR 09A

| MAKE / MODEL NO. | SPECIFICATION | COST | REFERENCE IMAGE |
|--|---|---------|-----------------|
| Signify BM21 LED25S | Construction Material: Aluminum Extrusion 1) Dimensions (mm): 1185 X 22 X 36 2) System Lumen O/P: > 2500lm 3) CCT: 6500K 4) Minimum System Efficacy: >110lm/w 5) Mounting Type: Surface/Wall 6) CRI > 80 7) THD < 20% 8) IP Rating: IP20 9) IK: 06 | 600.00 | |
| Signify BM21 LED25S | Construction Material: Aluminum Extrusion 1) Dimensions (mm): 1185 X 22 X 36 2) System Lumen O/P: > 2500lm 3) CCT: 6500K 4) Minimum System Efficacy: >110lm/w 5) Mounting Type: Surface/Wall 6) CRI > 80 7) THD < 20% 8) IP Rating: IP20 | 600.00 | |
| Signify BM21 LED25S | Construction Material: Aluminum Extrusion 1) Dimensions (mm): 1185 X 22 X 36 2) System Lumen O/P: > 2500lm 3) CCT: 6500K 4) Minimum System Efficacy: >110lm/w 5) Mounting Type: Surface/Wall 6) CRI > 80 7) THD < 20% 8) IP Rating: IP20 | 600.00 | |
| Signify BM170 LED40S | Construction Material: Aluminum Extrusion 1) Dimensions (mm): 1212 X 21 X 38.5 2) System Lumen O/P: > 4000lm 3) CCT: 4000/6500K 4) Minimum System Efficacy: >140lm/w 5) Mounting Type: Surface/Wall 6) CRI > 80 7) THD < 10% 8) IP Rating: IP40 | 1420.00 | |
| Signify BM021 LED25S | Construction Material: Aluminum Extruded 1) Dimensions (mm): 598 X 22 X 36 2) System Lumen O/P: > 1100-1200lm 3) CCT: 6500K 4) Minimum System Efficacy: >110lm/w 5) Mounting Type: Surface/Wall 6) CRI > 80 7) THD < 20% 8) IP Rating: IP20 9) Wattage: 10-11W | 500.00 | |
| Signify WF202 LED80S | Construction Material: PDC Aluminium 1) Dimensions (mm): 181 X 110 X 79 2) System Lumen O/P: > 1100LM 3) CCT: 6500K 4) Minimum System Efficacy: >110 lm/w 5) Mounting Type: Surface 6) CRI > 80 7) THD < 10% 8) IP Rating: IP65 9) IK: 09 | 1350.00 | |
| Signify HDL Model No. LED Surface light | Construction Material: Rust free synthetic 1) Dimensions (mm): 205mm Dia x 54mm (H) 2) System Lumen O/P: > 840LM 4) Minimum System Efficacy: >270 lm/w 5) Mounting Type: Surface/Wall mounted. 6) CRI > 80 8) IP Rating: IP65 | 2200.00 | |
| Signify HDL Model No. LED Surface light | Construction Material: Rust free synthetic 1) Dimensions (mm): 205mm Dia x 54mm (H) 2) System Lumen O/P: > 840LM 4) Minimum System Efficacy: >270 lm/w 5) Mounting Type: Surface/Wall mounted. 6) CRI > 80 8) IP Rating: IP65 | 2200.00 | |
| Signify SM101 LED55S | Construction Material: Pressure Die Cast Aluminium 1) Dimensions (mm): 76mm Dia x 170mm (H) 2) System Lumen O/P: > 1500LM 3) CCT: 3000/4000K 4) Minimum System Efficacy: >100 lm/w 5) Mounting Type: Surface wall & ceiling/Wall mounted/suspended 6) CRI > 80 8) IP Rating: IP65 | 2500.00 | |
| Signify DN296B LED20S | Construction Material: PDC Aluminium 1) Dimensions (mm): Ø 150mm Dia x 40mm (H) 2) System Lumen O/P: > 2000LM 3) CCT: 6500K 4) Minimum System Efficacy: >115lm/w 5) Mounting Type: Recessed mounted. 6) CRI > 80 7) THD < 10% 8) IP Rating: IP20 9) Wattage: 18W | 2400 | |
| Signify DN296B LED20S | Construction Material: PDC Aluminium 1) Dimensions (mm): Ø 150mm Dia x 40mm (H) 2) System Lumen O/P: > 2000LM 3) CCT: 6500K 4) Minimum System Efficacy: >115lm/w 5) Mounting Type: Recessed mounted. 6) CRI > 80 7) THD < 10% 8) IP Rating: IP20 9) Wattage: 18W | 2400 | |
| Signify Ecolink 15W Square Downlight | Construction Material: PDC Aluminium 1) Dimensions (mm): 136 x 136 mm Cut-Out 2) System Lumen O/P: > 1500lm 3) CCT: 6500K 4) Minimum System Efficacy: >100lm/w 5) Mounting Type: Recessed Mounted 6) CRI > 70 8) IP Rating: IP20 9) Wattage: 15W | 700.00 | |
| Signify BGP150 LED50/WW BV GM | Construction Material: PDC Aluminium 1) Dimensions (mm): 50 X 80 X 36.5 2) System Lumen O/P: > 520 lm 3) CCT: 3000K 4) Minimum System Efficacy: >65 lm/w 5) Mounting Type: Spike 6) CRI > 80 8) IP Rating: IP65 9) Wattage: 8W | 3760 | |

| MODEL NO. | SPECIFICATIONS | REF IMAGE |
|--------------------|--|-----------|
| ID NO.1595 | Construction Material: Polycarbonate 1) Dimensions (mm): 1137 x 22 x 34 2) System Lumen O/P: 1438 lm - CW 3) CCT: 3000K / 4000K / 6500K 4) Minimum System Efficacy: 78 lm / W 5) Mounting Type: Surface 6) CRI: > 80 7) THD < 10% 8) IP Rating: IP20 9) Wattage: 20W | |
| ID NO.1595 | Construction Material: Polycarbonate 1) Dimensions (mm): 1137 x 22 x 34 2) System Lumen O/P: 1438 lm - CW 3) CCT: 3000K / 4000K / 6500K 4) Minimum System Efficacy: 78 lm / W 5) Mounting Type: Surface 6) CRI: > 80 7) THD < 10% 8) IP Rating: IP20 9) Wattage: 20W | |
| ID NO.1595 | Construction Material: Polycarbonate 1) Dimensions (mm): 1137 x 22 x 34 2) System Lumen O/P: 1438 lm - CW 3) CCT: 3000K / 4000K / 6500K 4) Minimum System Efficacy: 78 lm / W 5) Mounting Type: Surface 6) CRI: > 80 7) THD < 10% 8) IP Rating: IP20 9) Wattage: 20W | |
| ID NO.1595 | Construction Material: Polycarbonate 1) Dimensions (mm): 1137 x 22 x 34 2) System Lumen O/P: 1438 lm - CW 3) CCT: 3000K / 4000K / 6500K 4) Minimum System Efficacy: 78 lm / W 5) Mounting Type: Surface 6) CRI: > 80 7) THD < 10% 8) IP Rating: IP20 9) Wattage: 20W | |
| ID NO.23225 | Construction Material: Polycarbonate 1) Dimensions (mm): 1000 x 25.7 x 7 | |
| ID NO.1597 | Construction Material: Engineering Plastic 1) Dimensions (mm): 579 x 35 x 78 2) System Lumen O/P: 900 lm - CW 3) CCT: 6500K 4) Minimum System Efficacy: 80 lm / W 5) Mounting Type: Wall / Surface 6) CRI: > 80 7) THD < 25% 8) IP Rating: IP20 9) Wattage: 10W | |
| ID NO.5616 | Construction Material: Aluminum 1) Dimensions (mm): 130 x 116 x 250 2) System Lumen O/P: 840 lm 3) CCT: 3000K / 4000K / 6500K 4) Minimum System Efficacy: 78 lm/w 5) Mounting Type: Surface 6) CRI: > 80 7) THD < 10% 8) IP Rating: IP54 9) Wattage: 12W | |
| ID NO.4032* | Construction Material: Die cast Aluminium 1) Dimensions (mm): Ø335 x 161 2) System Lumen O/P: 640 lm 3) CCT: 3000K / 4000K / 6500K 4) Minimum System Efficacy: 28 lm / W 5) Mounting Type: Surface and wall Mounted 6) CRI: > 80 7) THD < 10% 8) IP Rating: IP54 9) Wattage: 12W | |
| ID NO.4032* | Construction Material: Die cast Aluminium 1) Dimensions (mm): Ø335 x 161 2) System Lumen O/P: 640 lm 3) CCT: 3000K / 4000K / 6500K 4) Minimum System Efficacy: 28 lm / W 5) Mounting Type: Surface and wall Mounted 6) CRI: > 80 7) THD < 10% 8) IP Rating: IP54 9) Wattage: 12W | |
| ID No.3353 | Construction Material: Die Cast Aluminium 1) Dimensions (mm): Ø160 x 85mm 2) System Lumen O/P: 2736 lm - MV 3) CCT: 3000/4000/6500K 4) Minimum System Efficacy: 96.1 lm/w 5) Mounting Type: Recessed Mounted 6) CRI: > 80 7) THD < 10% 8) IP Rating: IP 20 9) Wattage: 30W | |
| ID No.3353 | Construction Material: Die Cast Aluminium 1) Dimensions (mm): Ø160 x 85mm 2) System Lumen O/P: 2736 lm - MV 3) CCT: 3000/4000/6500K 4) Minimum System Efficacy: 96.1 lm/w 5) Mounting Type: Recessed Mounted 6) CRI: > 80 7) THD < 10% 8) IP Rating: IP 20 9) Wattage: 30W | |
| ID NO.3360 | Construction Material: Die Cast Aluminium 1) Dimensions (mm): 100 X 100 X 110 2) System Lumen O/P: 1721 lm - CW 3) CCT: 3000/4000/6500K 4) Minimum System Efficacy: 92 lm/w 5) Mounting Type: Recessed Mounted 6) CRI: > 70 7) THD < 20% 8) IP Rating: IP 20 9) Wattage: 15W | |
| ID NO.7057 | Construction Material: Die Cast Aluminium 1) Dimensions (mm): 100 X 100 X 110 2) System Lumen O/P: 660 lm 3) CCT: 3000/4000/6500K 4) Minimum System Efficacy: 85 lm/w 5) Mounting Type: Surface 6) CRI: > 80 7) THD < 20% 8) IP Rating: IP65 9) Wattage: 7W | |

NOTES

- Dimensions are not to be scaled.
- All dimensions are in millimeters unless stated otherwise.
- All levels are in millimeters and relate to given datum level.
- The contractor shall verify all dimensions, details, specifications & site conditions & shall report any error, omission and/or anomaly to the campus designer before commencement of work.
- For construction purposes, the dimensions shall not be measured directly of the drawings, the drawings shall not be used for construction until they are revised for construction.
- These drawings are to be read in co-ordination with hvac, electrical, plumbing, it drawings & all relevant sections of specifications.
- All shop drawings should be provided to the campus designer for approval.
- Provide shop drawings on the bottom of all vertical edges and surfaces (concrete, stone, plaster, etc) as per dimensions and shape provided in detail.
- Shuttering pattern drawing to be provided to the campus designer for approval.
- Vendors to provide shop drawings for the approval from the campus designer.
- Shuttering drawing shall be drawn to reflect the real locations, for side should be equally spaced and aligned according to the shuttering pattern. consider: for top pvc dia =18mm and pvc cone dia=20mm

| ISSUES | | |
|----------|-------------|------|
| REVISION | DESCRIPTION | DATE |
| | | |
| | | |
| | | |
| | | |







INDIAN INSTITUTE OF TECHNOLOGY (IIT) HYDERABAD
 Approved Campus - Project Office
 Area: High, Sangareddy Road
 Near: District, Andhra Pradesh - 502205



CAMPUS DESIGNER:
ARCOP ASSOCIATES PVT LTD
 A-16 Parkside Enclave, G.K.1
 New Delhi - 110048
 Phone: 011-2648268

Architect's Signature: _____ Client's Signature: _____

DATE: 08 OCTOBER 2025
 Drawing Title: MASTER SCHEDULE OF LIGHT MODULE NOS 1
 Document Release Type: TENDER/ GOOD FOR CONSTRUCTION
 Job No: 2025/05 NORTH
 Scale: 1:100
 Drawn by: KK
 Checked by: SS
 Authority: _____

ELECTRICAL FIXTURE SCHEDULE

| | | | | | | | | |
|----|--------------|-------------|---|-------------------------------------|--------------------------------|--|-------|---|
| 28 | | CEILING FAN |  | 3_CEILING MOUNTED_FAN | CROMPTON- B00HWVJ00 | DIM-1200 SPEED-370 WATT-70 | 2339 |  |
| 29 | WALL MOUNTED | EXHAUST FAN |  | 3_EXHAUST FAN | CROMPTON S0L095784694 | 200MM, SPEED-1300 WATT-30 | 1225 |  |
| 30 | WALL MOUNTED | SWITCHES |  | 3_WALL_MODULES_DATA/ POWER/LIGHTING | LEGRAND ARTEOR | | |  |
| 31 | Strip Light | Gate | | | LS27-005-120-WW-50 - LPV-60-24 | Construction Material: Flexible Frosted Encapsulated 1) Dimensions (mm): 10X10mm cross Section 2) System Lumen Cp: > 530lm/m 3) Wattage: 10W/m, 4m Spools 4) CCT: 3000K 5) Mounting Type: Inside C Al Channel 6) CRI > 70 7) IP Rating: > IP67 | 23500 |  |

| | | |
|--------------------------------------|---|---|
| Signify Ecolink zoom ceiling Fan 75W | Signify Ecolink zoom ceiling Fan 75W, 400 RPM, 1200mm Sweep |  |
| Signify Ecolink EXHAUST FAN | EXHAUST/VENTILATION FANS Suitable for kitchens and washrooms, these fans are great for improving the indoor air quality and getting rid of bad odours. They also help getting rid of excessive moisture in places. |  |
| Signify Switch | Signify One-Way Switch |  |

NOTES

- Dimensions are not to be scaled.
- All dimensions are in millimeters unless stated otherwise.
- All levels are in millimeters and relate to given datum level.
- The contractor shall verify all dimensions, details, specifications & site conditions & shall report any error, omission and/or anomaly to the campus designer before commencement of work.
- For construction purposes, the dimensions shall not be measured directly of the drawings, the drawings shall not be used for construction until they are issued for construction.
- Drawings are to be read in co-ordination with hvac, electrical, plumbing, it drawings & all relevant sections of specifications.
- All shop drawings should be provided to the campus designer for approval.
- Provide shop courses on the bottom of all external horizontal edges and surfaces (concrete, stone, plaster, etc) as per dimensions and shape provided in detail.
- Shuttering pattern drawing to be provided to the campus designer for approval.
- Vendors to provide shop drawings for the approval from the campus designer.
- Shuttering elevation shop drawing to reflect the rod locations, the rods should be equally spaced and aligned according to the shuttering pattern. consider: tie rod pvc dia =16mm and pvc cone dia=20mm

ISSUES

| REVISION | DESCRIPTION | DATE |
|----------|-------------|------|
| | | |
| | | |
| | | |
| | | |
| | | |
| | | |
| | | |
| | | |
| | | |
| | | |
| | | |

Shop drawings to be provided to the campus designer for approval. Vendors to provide shop drawings for the approval from the campus designer.

CLIENTS :
 INDIAN INSTITUTE OF TECHNOLOGY (IIT) HYDERABAD
 Purnima Campus - Project Office
 Kandi Road, Sangareddy District
 Nalgonda District, Andhra Pradesh - 502205

CAMPUS DESIGNER:
 ANCOF ASSOCIATES PVT LTD
 A-16 Pampash Chandra, G.K.1
 New Delhi - 110044
 Phone : 911-2642988

Architect's Signature _____ Client's Signature _____

ISS: 155
 INDIAN INSTITUTE OF TECHNOLOGY HYDERABAD
 INTEGRATED DIRECTOR RESIDENCE AND OFFICE COMPLEX

Drawing Title
MASTER SCHEDULE OF LIGHT MODULE NOS 3

Document Release Type
TENDER/ GOOD FOR CONSTRUCTION

| | | |
|--------------------|-----------------|---|
| Job No. | 2025/05 | NORTH |
| Scale | 1 : 100 |  |
| 08 OCTOBER 2025 | 08 OCTOBER 2025 | |
| Drawn by | KK | Drawing No. BLD-AR-09C |
| Checked by | SS | Revision No. RO |
| AUTHORITY : | | |